

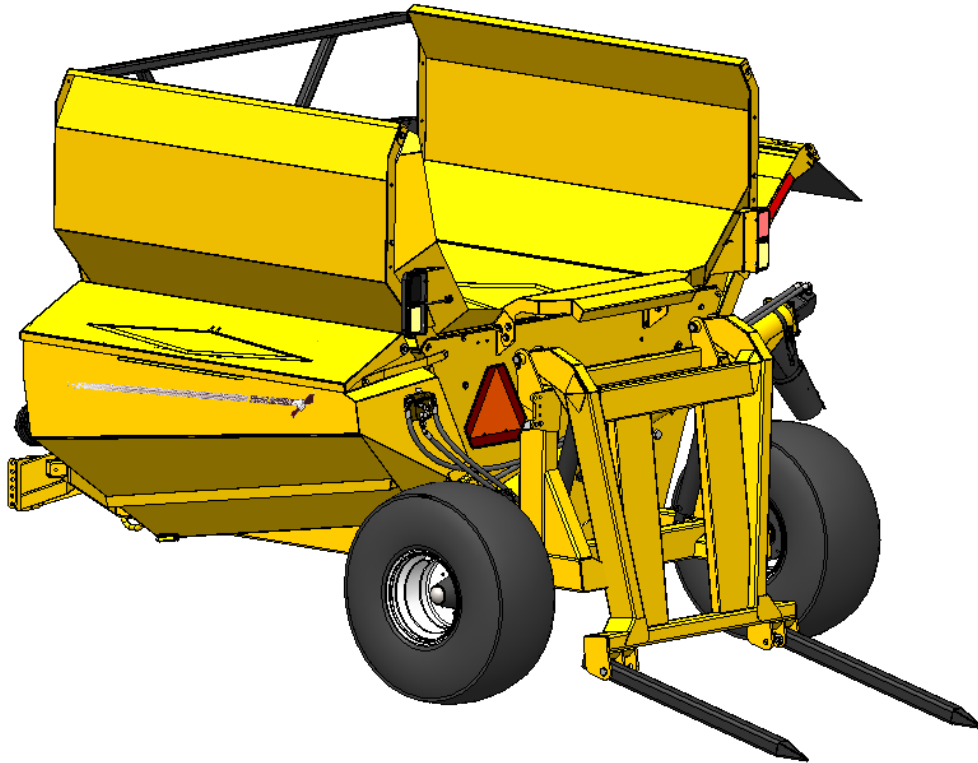

BRIDGEVIEW MFG. INC.



BALE KING 5300TR
Total Ration Grain Tank Kit

Operator's & Parts Manual

Last Updated: December 2023

Bridgeview Manufacturing Inc.

P.O. Box 4

Gerald, Saskatchewan, Canada

S0A 1B0

Phone: 1-306-745-2711

Fax: 1-306-745-3364

Email: bmi@sasktel.net

www.bridgeviewmanufacturing.com



Your Authorized Dealer
Your Serial Number

The Serial Number is located on the front tank panel.

	⚠ WARNING
	Failure to read and understand operator's manual & all safety signs could result in serious injury. Manual must remain with machine.



TABLE OF CONTENTS

FEATURES AND OPERATION.....	4
Hydraulics.....	5
Diverter Control Box.....	6
Transportation.....	7
Troubleshooting Guide.....	7
INSTALLATION MANUAL.....	8
PARTS MANUAL.....	27
Wheels & Hub.....	27
Spindle.....	28
Front Tub Components.....	29
Slow Moving Vehicle (SMV) Sign Kit.....	30
PTO Holder.....	31
Decals.....	33
Total Ration Grain Tank Kit Option.....	35
Total Ration Tank Front.....	36
Total Ration Tank Rear.....	38
Total Ration Cross Auger.....	40
Total Ration Tank Lid.....	42
HYDRAULIC AND ELECTRICAL SCHEMATICS.....	43
Hydraulics.....	43
Diverter Control Box.....	53

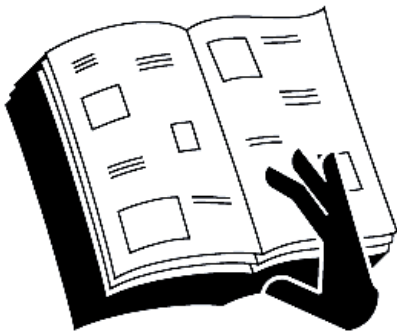

FEATURES AND OPERATION



The Bale King 5300 has an available 40-bushel grain tank, which allows grain to be discharged on top of a windrow of processed hay, or independently out the right side of the machine. This bolt-on kit changes the processor to a 5300TR (Total Ration).

The tank is located on the left side of the machine and features a large opening, 5 ft off the ground for easy filling. A flow control valve allows you to adjust the speed of the augers so that you can meter the grain flow for different situations. It is recommended to determine your desired rate based on driving speed and the flow rate of the tractor. Setting the valve to "0" will give no grain, while setting it to "10" will be full speed.

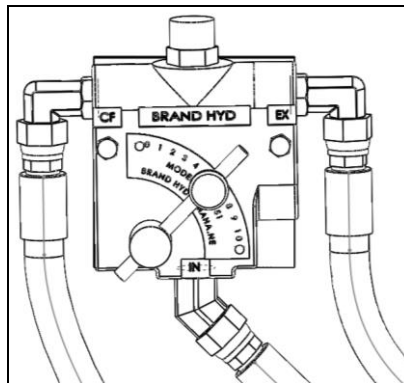

Cleanout doors are located at the bottom end of both the cross-auger, and the grain tank. It is recommended that both be cleaned out at the end of every season.



Hydraulics

The grain tank has the option of running using two, three, or four sets of hoses. Each hose has a coloured marker to identify its function. They should be connected at best convenience for the tractor's controls. Note that the hoses are paired by colour and the following tables show the operation when pushing oil into the hose with the longer marker.

The column on the left shows the part number of the required hydraulic kit to set-up the machine with the desired number of remotes.

5300TR – 2 Remote	
22045	Control Box “AUXILIARY” “FORK” “DEFLECTOR”
	Long Blue Discharge grain Lift rear fork Lift deflector
	Long Red Agitators rotate clockwise
5300TR – 3 Remote	
22044	Control Box “FORK” “DEFLECTOR”
	Long Blue Lift rear fork Lift deflector
	Long Red Agitators rotate clockwise
	Long Green Discharge grain
5300TR – 4 Remote	
22043	Long Blue Lift rear fork
	Long Red Agitators rotate clockwise
	Long Yellow Lift deflector
	Long Green Discharge grain

If the machine already has an optional 3-Bale Kit installed, the hydraulic kit options are as shown below:

5300XTR – 2 Remote	
32006	Control Box * “GRAIN TANK” “AUXILIARY” “FORK” “DEFLECTOR”
	Long Blue Discharge grain Clamp bale Lift rear fork Lift deflector
	Long Red Agitators rotate clockwise
5300XTR – 3 Remote	
32005	Control Box “AUXILIARY” “FORK” “DEFLECTOR”
	Long Blue Clamp bale Lift rear fork Lift deflector
	Long Red Agitators rotate clockwise
	Long Green Discharge grain
5300XTR – 4 Remote	
32007	Control Box “FORK” “DEFLECTOR”
	Long Blue Lift rear fork Lift deflector
	Long Red Agitators rotate clockwise
	Long Yellow Clamp bale
	Long Green Discharge grain

Diverter Control Box

The Bale King 5300TR may require a diverter kit which allows it to operate using fewer hydraulic remotes. The fork and deflector (and possibly grain tank or three bale clam) functions are then controlled by a cab-mounted switch box. This box must be wired up to the tractor's electrical system. You may use the provided plug to plug into the accessory outlet. If this is not available, the plug can be disassembled, and wired as necessary.

Black Wire	White Wire
+12V (Ignition Switched)	-12 V / Ground

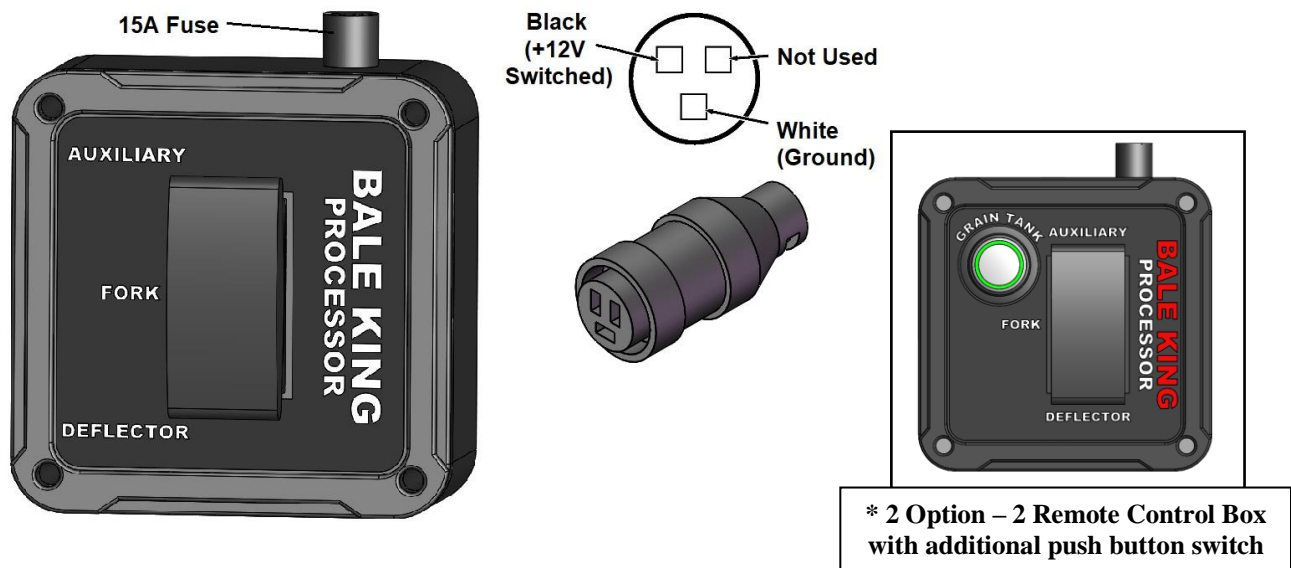

A 4-pin plug is used to power the diverter valve on the processor. If no power is supplied, the hydraulics will still control the rear forks, but the deflector will not be functional. If the switch in the tractor is activated, the deflector can be controlled. On 5300 machines with an optional “TR” Grain Tank or “X” Three Bale Kit, this box can also control grain flow or the 3 Bale Clamp (as “Auxiliary”).

The diverter kit also features a pilot operated check valve to ensure that the deflector will not fall down due to leaking across the valve.

Transportation

The transport dimensions of the base processor change with the addition of the Total Ration grain tank. Keep this in mind when towing on public roads.

	Empty			Loaded		
	5300	5300X ¹	5300TR ²	5300	5300X ¹	5300TR ²
Total Weight	4400 lb	5070 lb	5200 lb	8000 lb	10 500 lb	10 750 lb
Hitch Weight	1250 lb	1320 lb	1540 lb	2000 lb	1600 lb	2200 lb
Length	16'-6"	16'-6"	16'-6"	20'-10"	20'-10"	20'-10"
Width ³	9'-10"	9'-10"	10'-9"	9'-9"	9'-9"	10'-7"
Height	8'-7"	8'-7"	8'-7"	11'-0"	11'-8"	11'-0"

Troubleshooting Guide

Problem	Possible Cause	Remedy
No grain flow	Flow control valve set too low	<ul style="list-style-type: none"> • Increase flow rate in tractor or on flow control valve
Flow control valve going over relief	Flow control valve relief pressure set too low	<ul style="list-style-type: none"> • Use hydraulic pressure gauge to ensure relief pressure is set to 2200psi.
	Auger chute at too shallow of an angle for grain to clear fast enough	<ul style="list-style-type: none"> • Run auger slower • Run chute at steeper angle

INSTALLATION MANUAL

STEP 1: Support the rear axle on blocks and remove the left side tire. Ensure that the front end is also securely supported (not just by the jack).

STEP 2: Remove the hub and spindle from the left side. Set aside for later use. Remove the SMV sign from the rear tub panel.

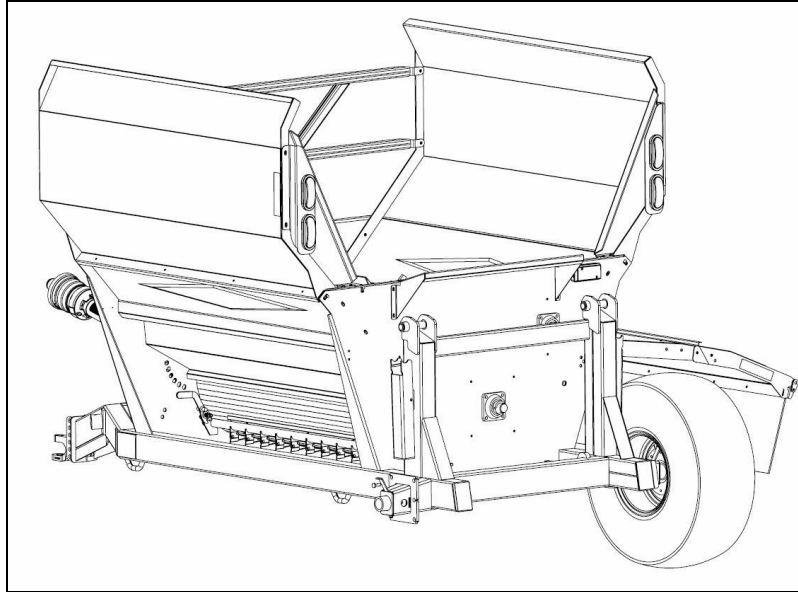

STEP 3: Install the axle extension on the, leave tire and spindle off for ease of installation of the tank and cross auger.

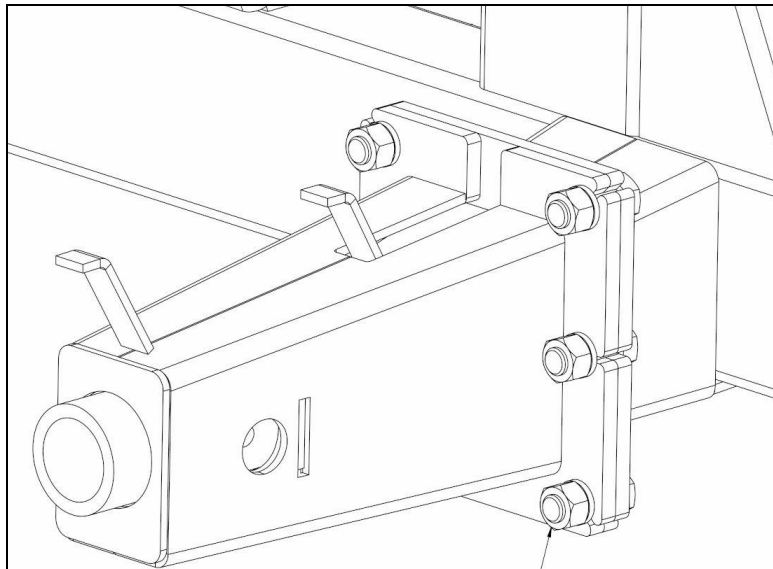

30259 Axle Extension	1
13800 Bolt, 3/4" x 2"	6
13795 Washer, 3/4" Lock	6
10283 Nut, 3/4"	6

STEP 4: Install mounting brackets onto grain tank.

- Remove shipping brackets, crate, auger pipe, augers and lid from the tank.
- Bolt on the mounting brackets to the grain tank.

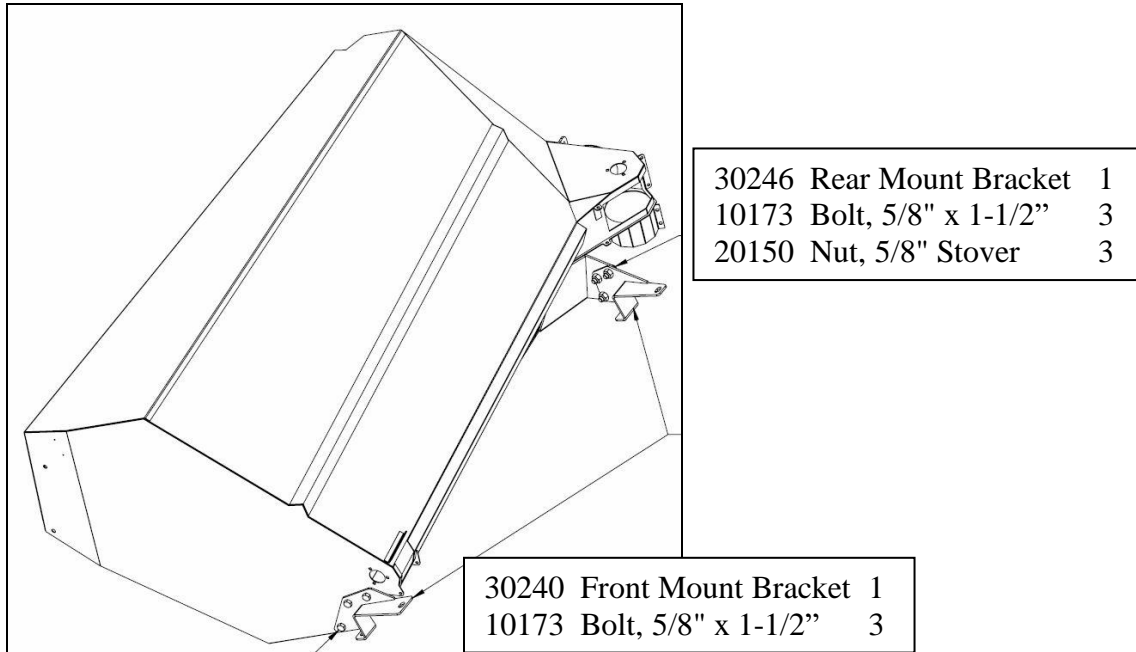

STEP 5: Install the grain tank to the left side of the processor.

- Tie a strap around the middle support bracket on the inside of the tank, push strap as close to the inside of the machine as possible.
- Push bottom of tank into machine and set the mounting brackets onto the frame tubing.

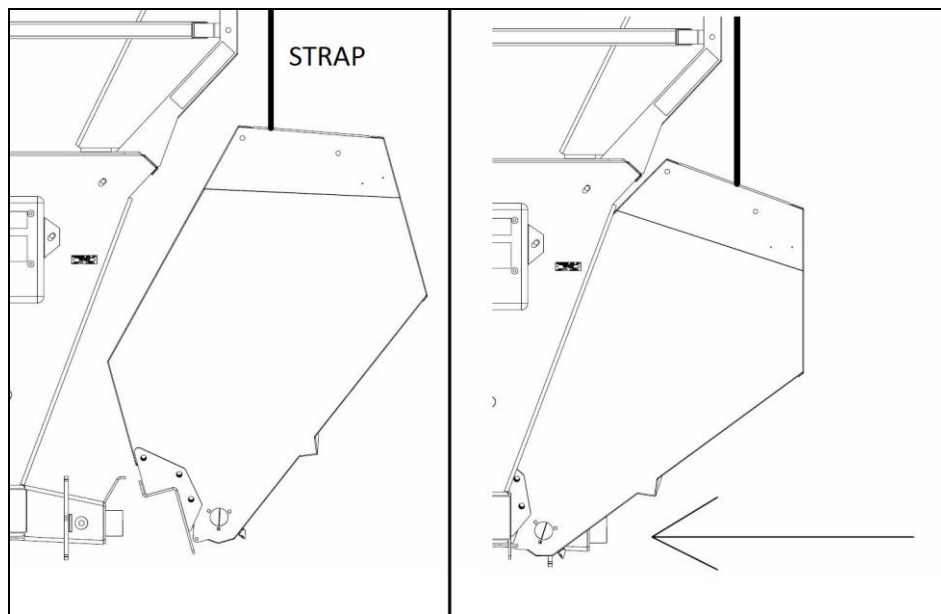

- Attach bottom mounts with the mounting straps and attach the top using the bars to connect to one of the wing bolts.

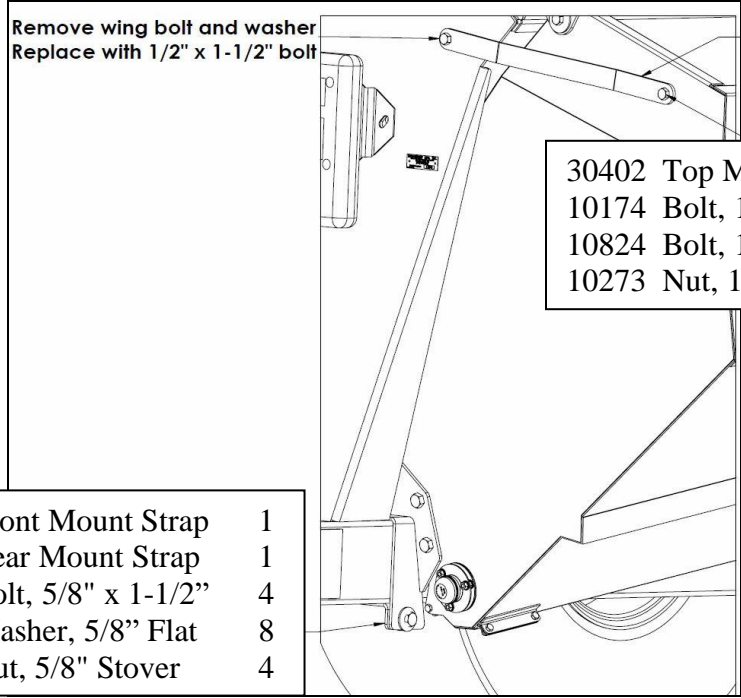

STEP 6: Install grain tank lid and lid support.

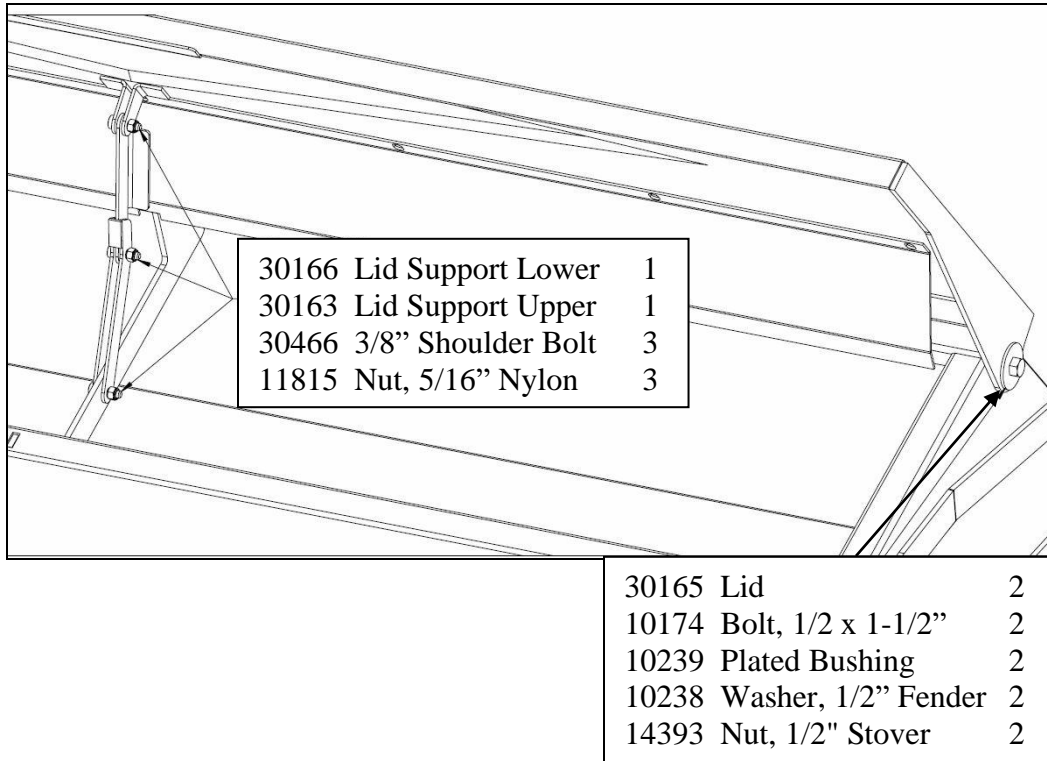

STEP 7: Install cross auger support to the rear deflector pivot. Remove 1 bolt at a time while supporting the lowered deflector.

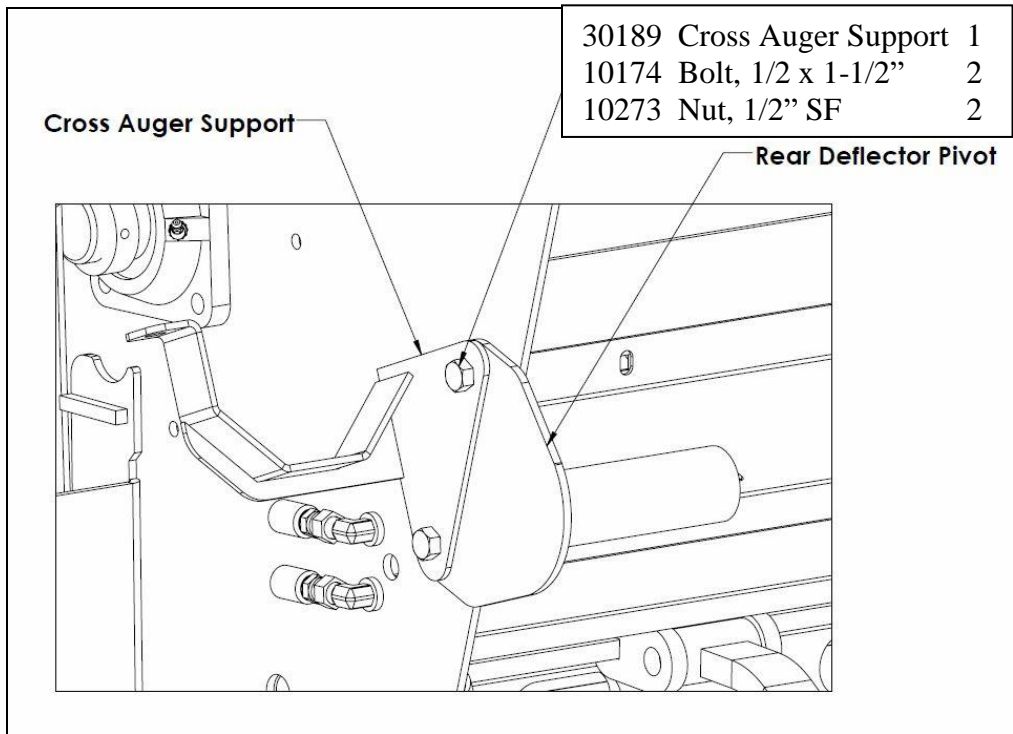

STEP 8: Install cross auger pipe.

- Insert between agitator and rotor shaft stubs from the right side
- Rest top end on cross auger support
- Run bottom end into grain tank until the stop on the pipe bottoms out against the half clamp on the tank.
- Clamp the bottom of the auger in place with the other half clamp. Run silicone all around the clamp joint to keep water from entering the tank.
- Clamp the top of the auger in place with the top side clamp.

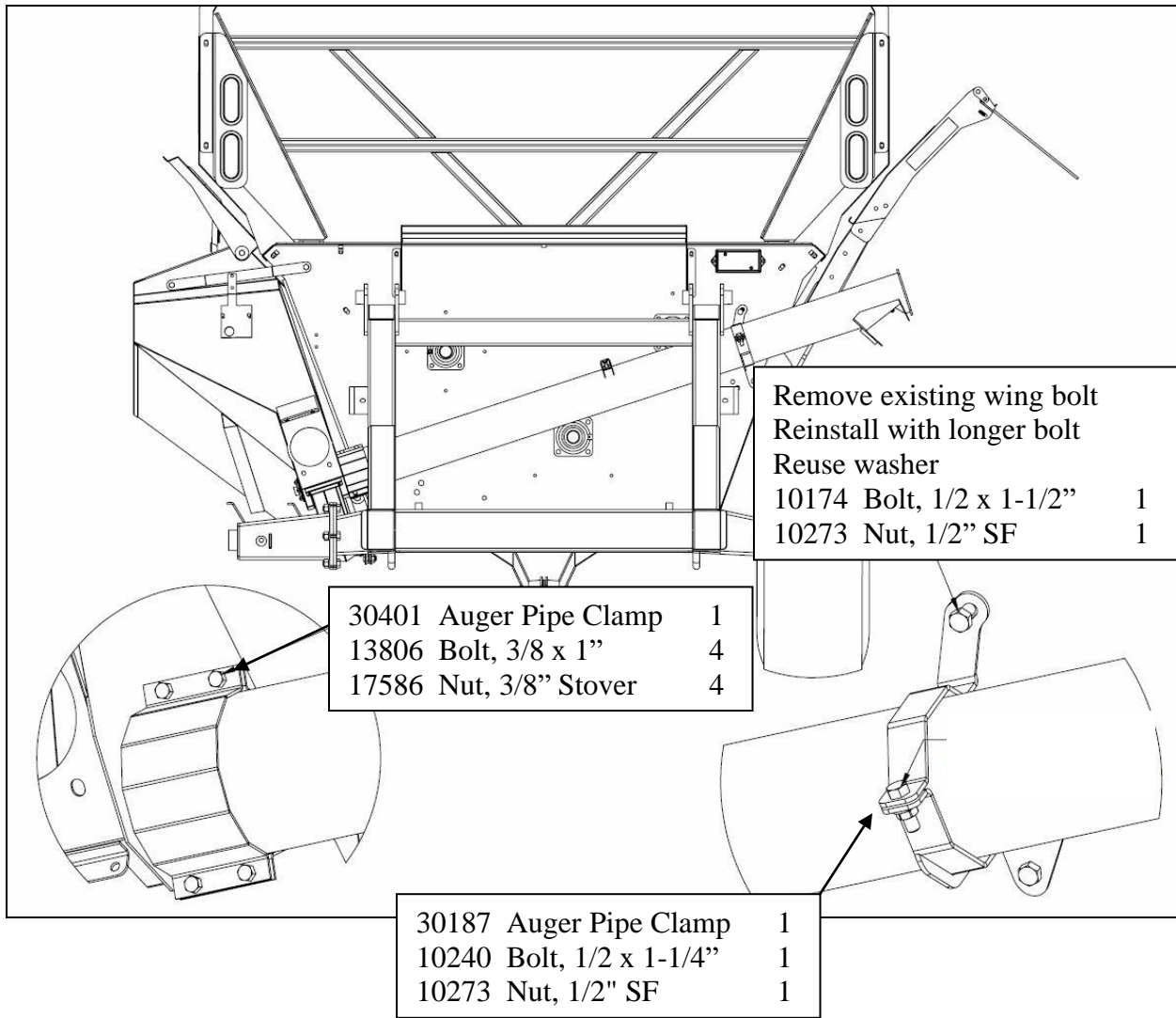

STEP 9: Install tank auger.

- Bolt tank motor (larger of the two) to the motor mount plate (ports down to the right) and the tank auger (~80" long, shorter of the two augers)
- Bolt the bearing to the bottom front of the tank
- Slide the auger through the tank and through the bearing
- Bolt the motor flange to the tank
- Install the bearing lock collar (clockwise)
- Install bearing cover
- Install the tank cleanout door

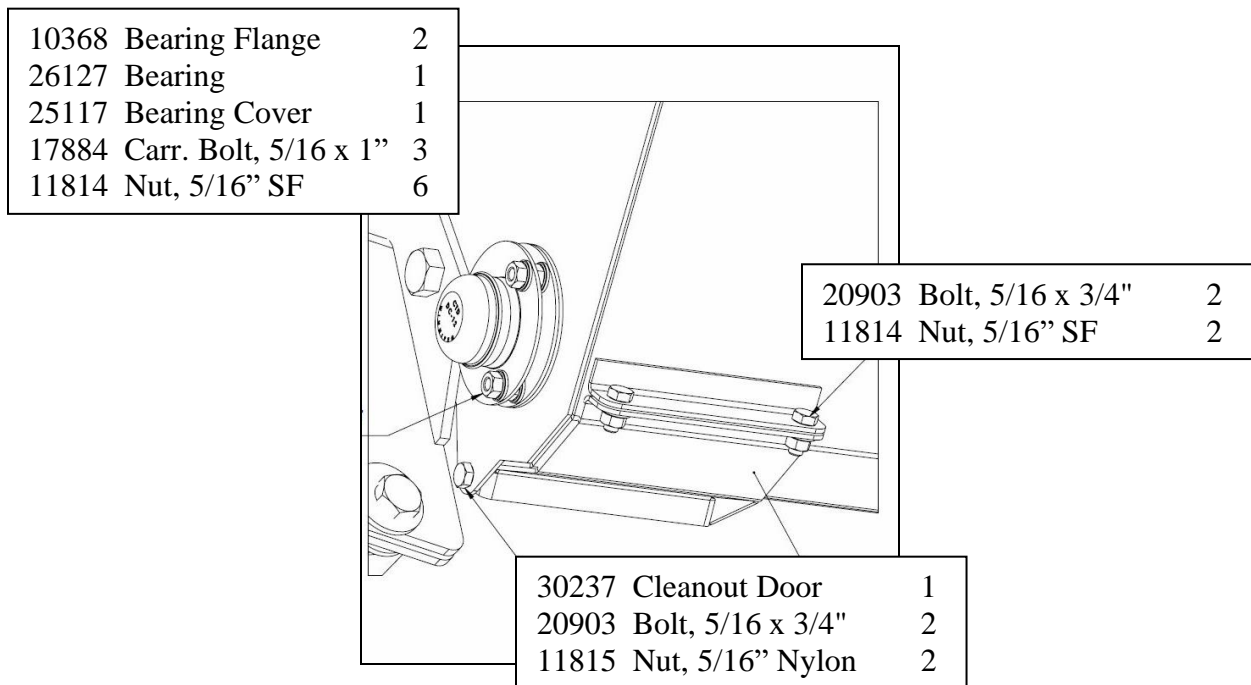
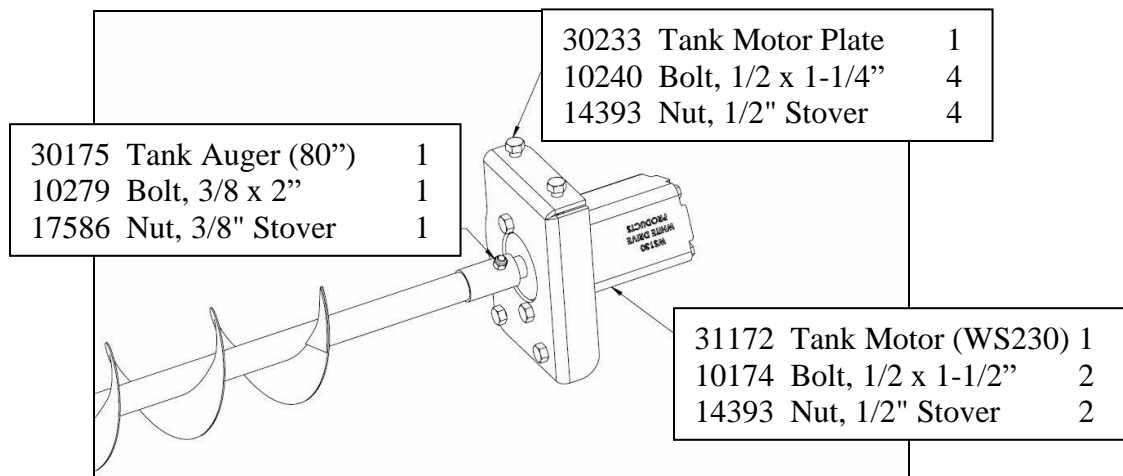

STEP 10: Install cross auger.

- Repeat above steps using longer auger (~95")
- Install the smaller motor (WS080) # 30132 to the end plate. Fittings upward. Chain catch downward.
- Bearing lock collar tightened clockwise. No bearing cover required
- Install rear tank cleanout door (longer of the two)

30169 Tank Auger (95")	1
10279 Bolt, 3/8 x 2"	1
17586 Nut, 3/8" Stover	1

30132 Tank Motor (WS080)	1
10174 Bolt, 1/2 x 1-1/2"	2
14393 Nut, 1/2" Stover	2

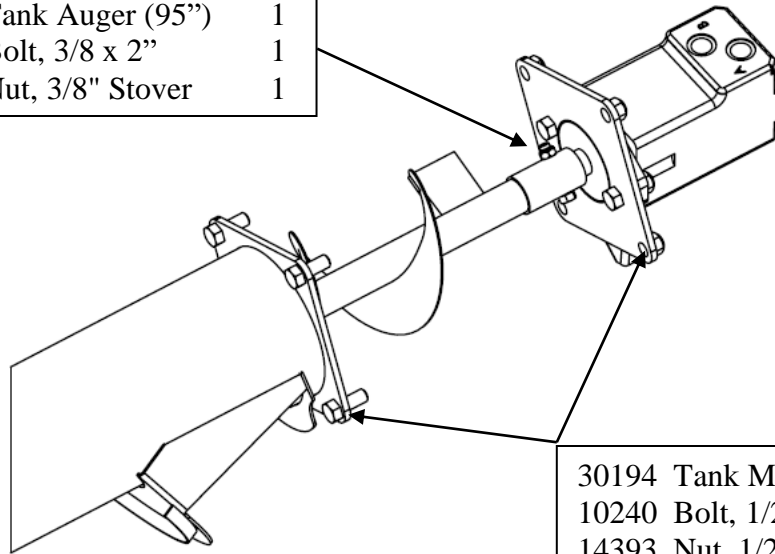

30194 Tank Motor Plate	1
10240 Bolt, 1/2 x 1-1/4"	4
14393 Nut, 1/2" Stover	4

10368 Bearing Flange	2
26127 Bearing	1
17884 Car. Bolt, 5/16x3/4"	3
11814 Nut, 5/16" SF	3

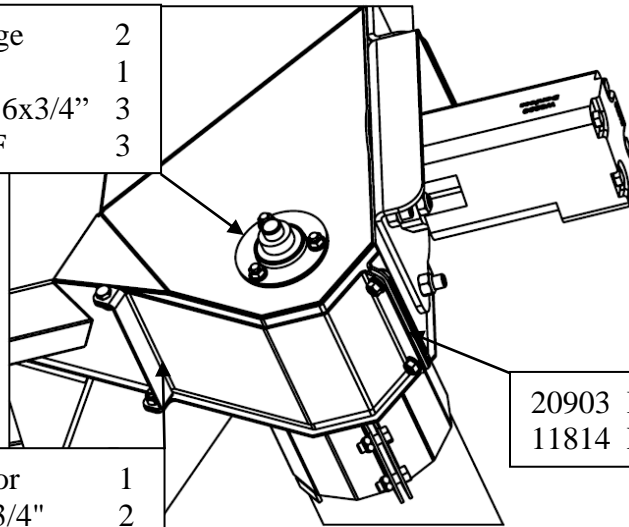

20903 Bolt, 5/16 x 3/4"	2
11814 Nut, 5/16" SF	2

30235 Cleanout Door	1
20903 Bolt, 5/16 x 3/4"	2
11815 Nut, 5/16" Nylon	2

STEP 11: Route hoses.

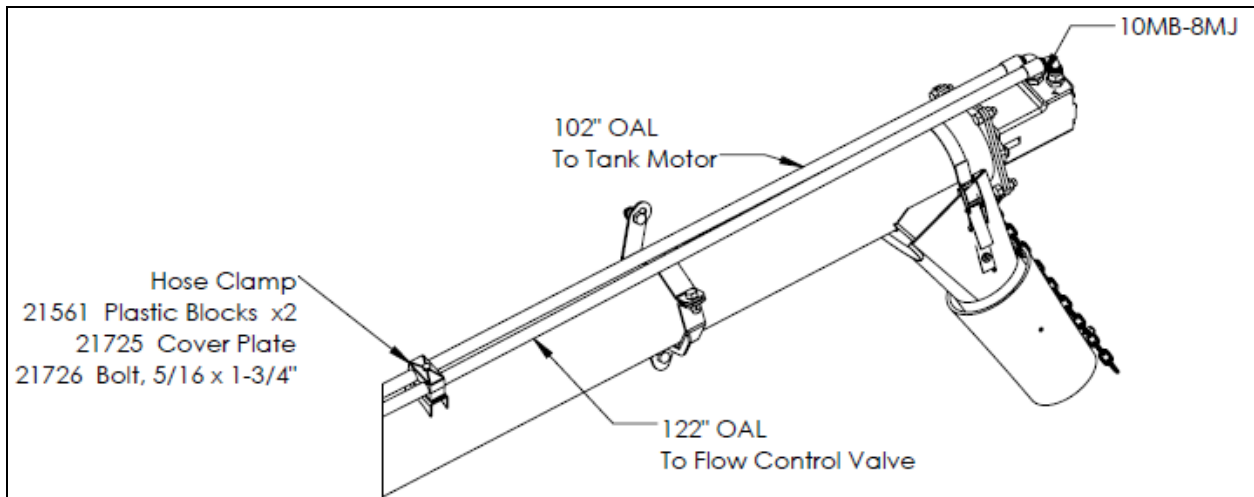
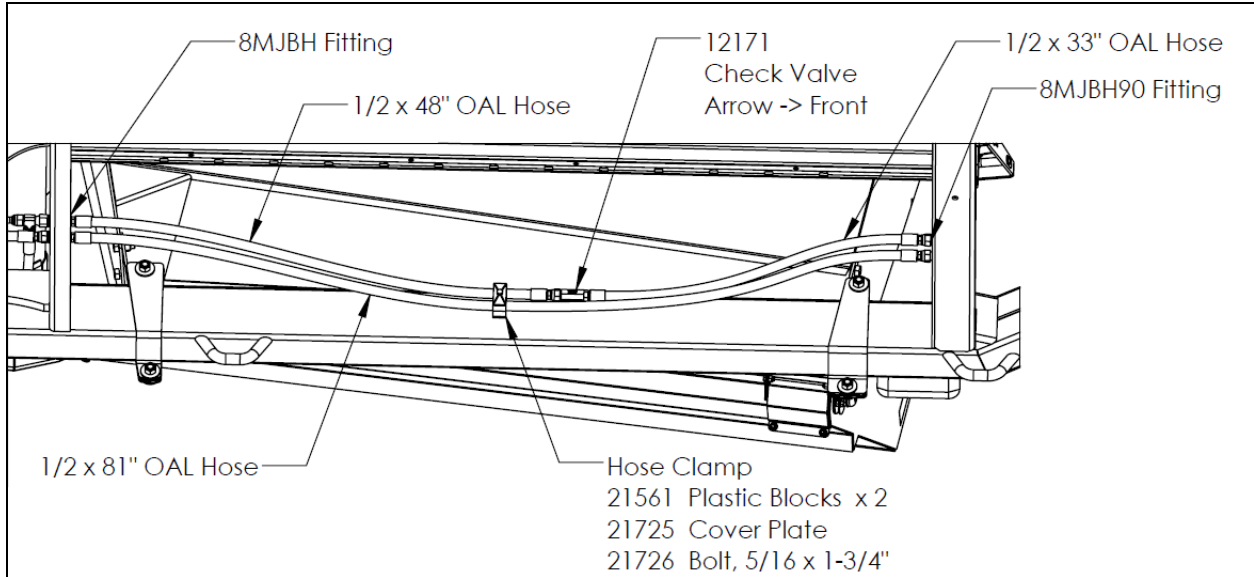

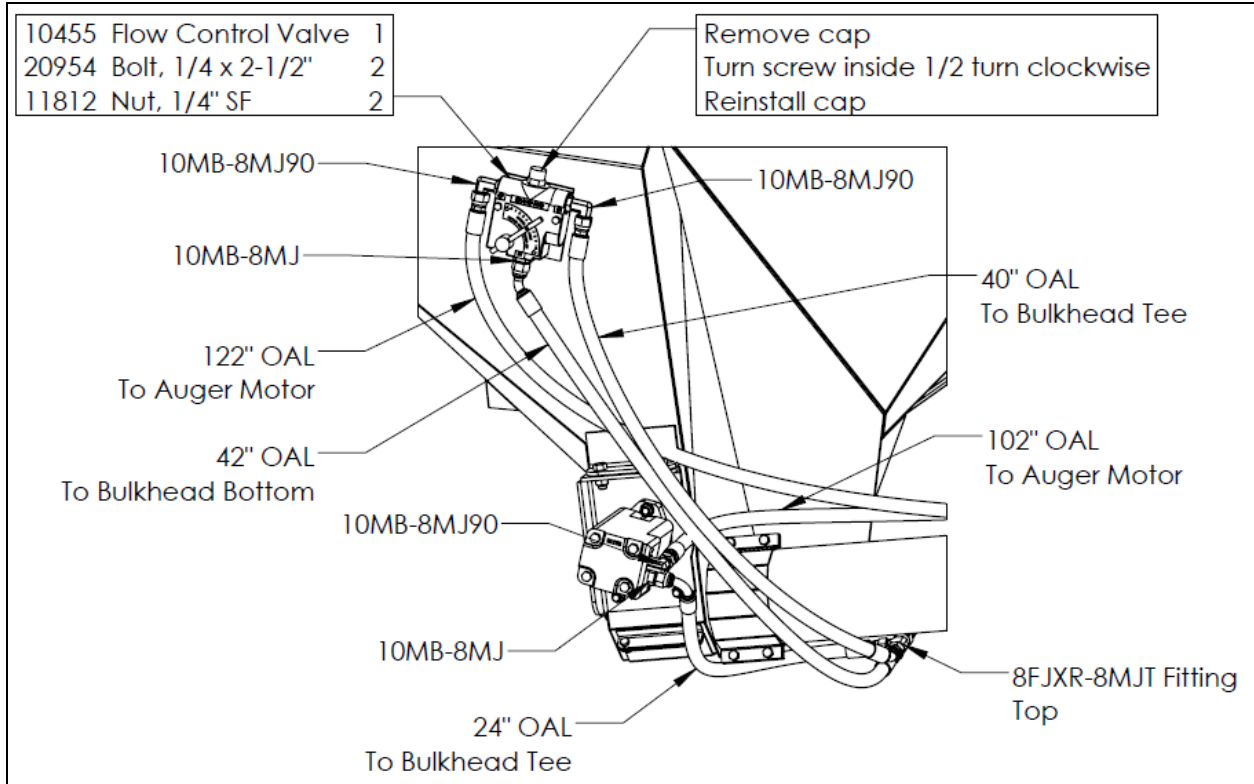

STEP 12: Install tractor hoses and diverter valve (as required).

Depending on the original set-up of the processor, and other options, the routing of the front hoses will be different. Determine your set-up. The 5 digit number represents the hose kit that is required. then proceed to the relevant section.

Optional 3 Bale Kit	Yes		No	
	32007	12.A, C	22043	12.A, C
4-Remotes	32007	12.A, C	22043	12.A, C
3-Remotes	32005	12.A, C	22044	12.A, C
2-Remotes	32006	12.B, C	22045	12.B, C

12.A Run 1/2" x 160" OAL hoses from the tractor end to the bulkhead. Install green markers to the hoses, with the longer one connected to the bottom bulkhead fitting. Run along the bottom of the tub, around the gearbox and then up to the hose holder, then to the tractor. Use the provided hose clamps to fix to the bottom of the tub.

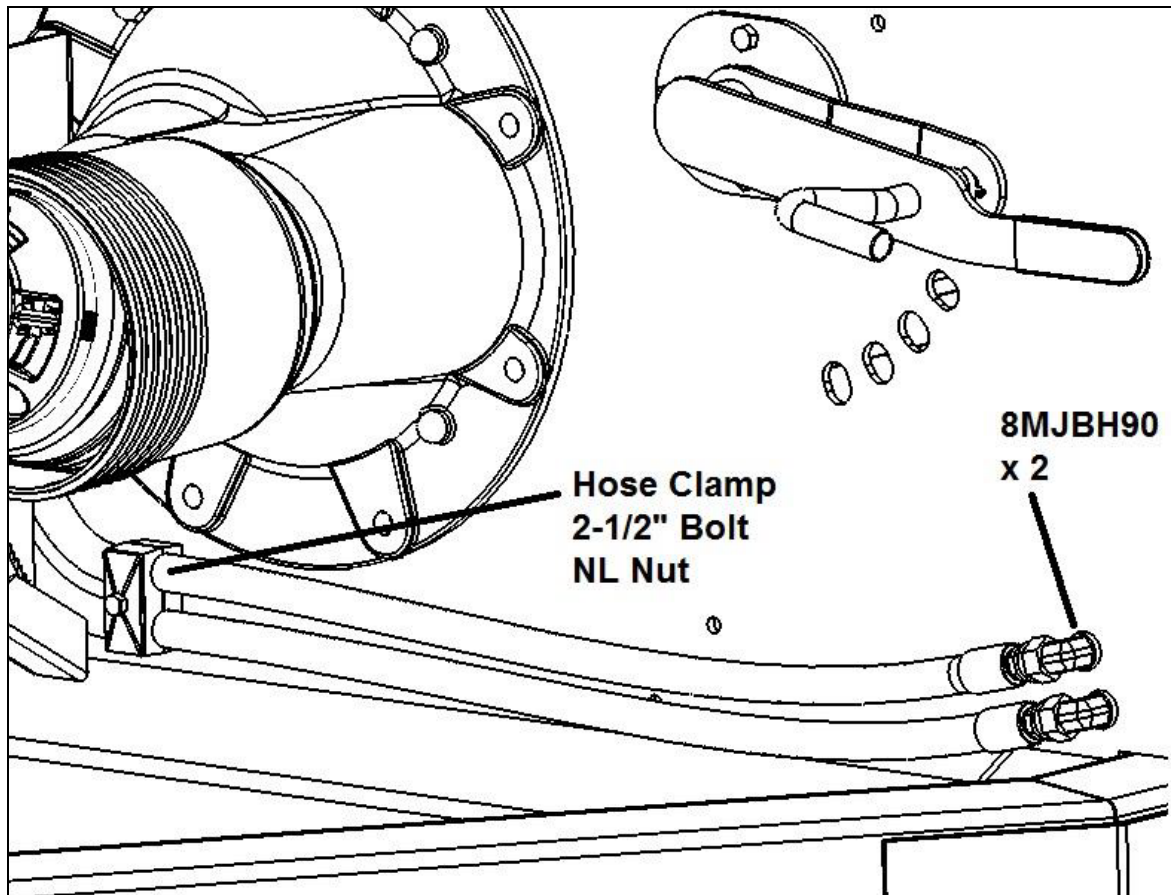

12.B1 Install fittings into the diverter valve block(s) as shown. Leave loose until after hoses are installed to find proper orientation.

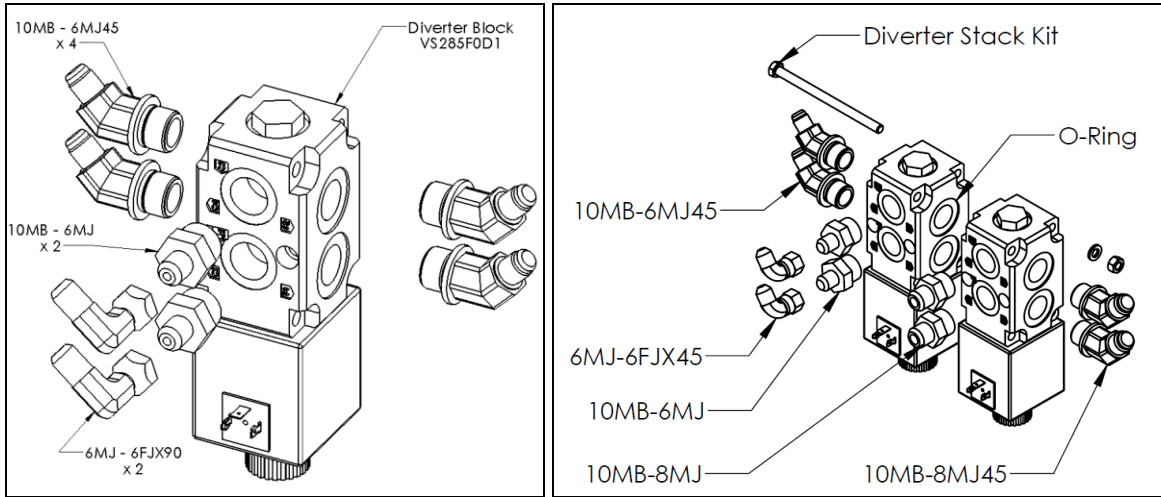

3-Remote Setup

2-Remote Setup

12.B2 Install diverter valve to the slotted holes in the front wall of the tub using 5/16" hardware. **Make sure that the plastic electrical box is DOWN.** Leave loose until all hoses are installed, then move to a position that works best for hose routing.

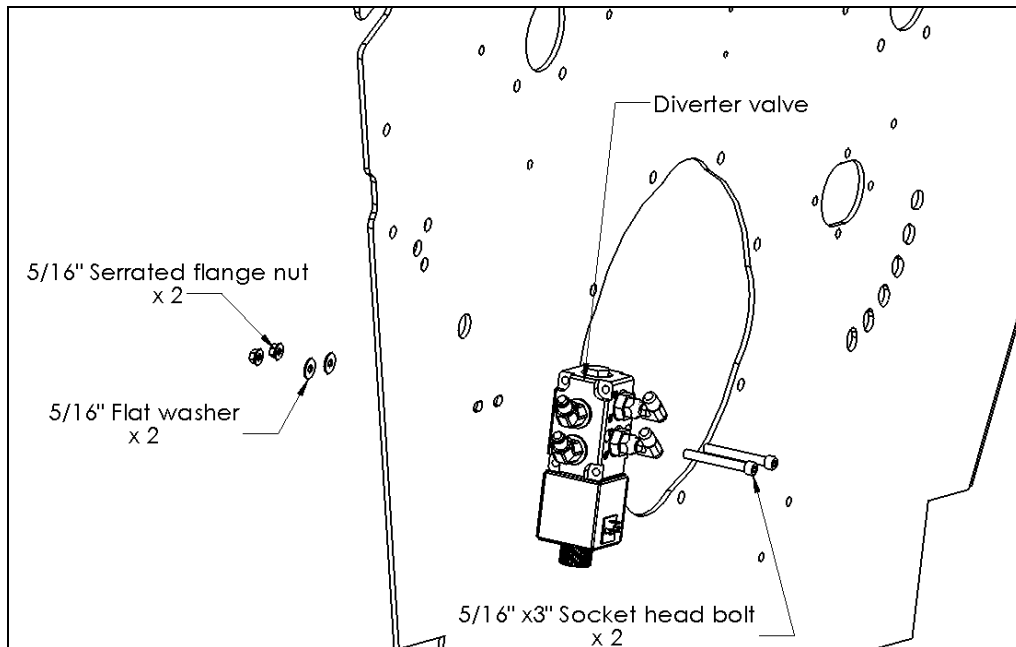



12.B3 Remove the 3/8" hoses from the bulkhead fitting on the left side of the machine and re-route them to the right side of the diverter. Find the hose marked with longer blue marker (near the tractor tip) and make sure that it connects to the bottom port. Tighten all fittings.

NOTE: For 2-Remote set-up, the 3/8" hose needs to be replaced by the provided 1/2" x 122" hose.

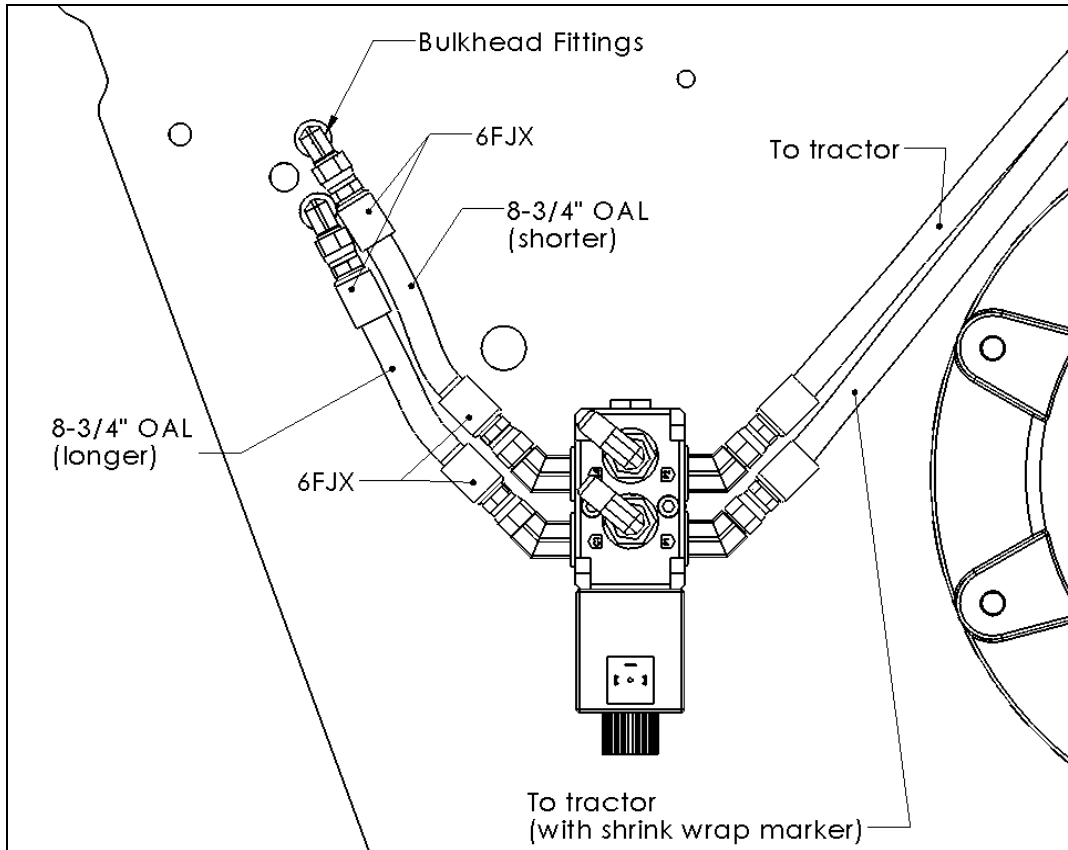

12.B4 Loosen the bulkhead fittings on the front wall (you will have to remove the bulkhead cover plate and two bolts). Measure the two short 3/8" hoses and find the longer and shorter ones (if different), then attach to the bulkhead fittings and the diverter as shown. Rotate fittings to get best fit, then tighten.

12.B5 Install fittings into the line lock as shown, then bolt the line lock to the front tub panel. Remove 1 existing twine guard bolt.

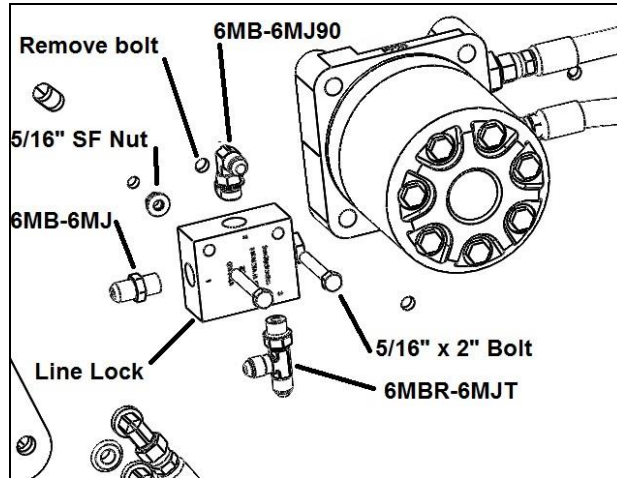

12.B6 Remove the 1/4" hoses from the deflector cylinder. Run the new 1/4" hoses from the deflector cylinder to the diverter valve and line lock as shown. Tighten all fittings.

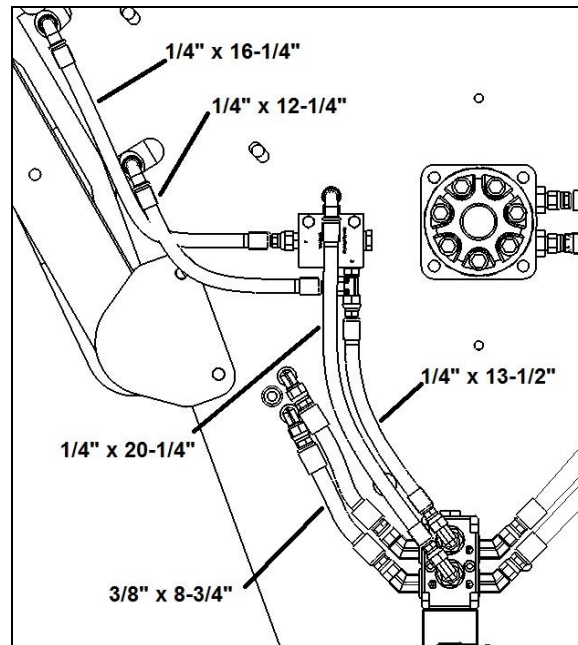

12.B7 Two-remote kits only. Run 1/2 x 44.5” hoses from the inside diverter across the bottom of the tub to the TR tank bulkhead fittings. Bottom of diverter goes to bottom of bulkhead.

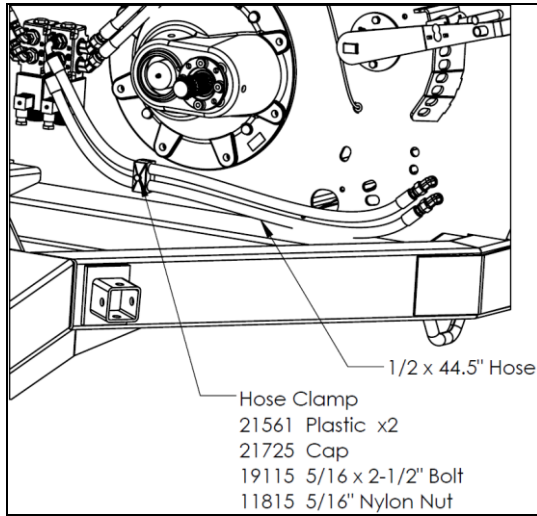

TR Only

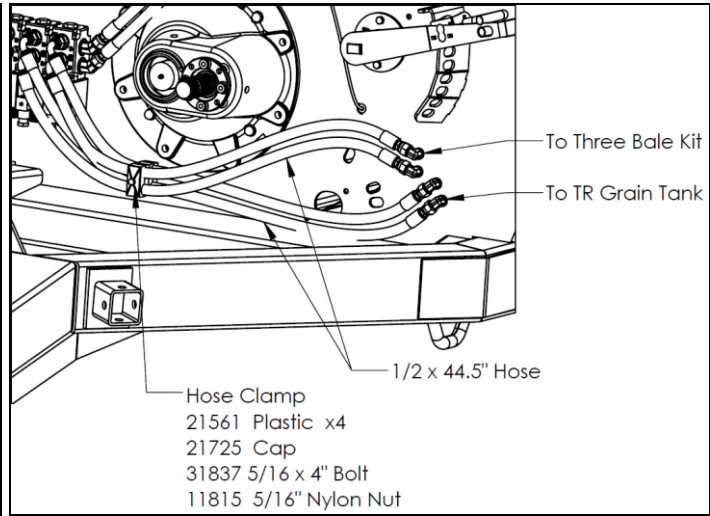

TR and Three Bale Kit

12.B8 Run 10' wire with 4-pin plug from the tractor to the diverter valve, alongside the hoses. Connect the diverter end to the square electrical plug as per schematic. Pop the insert out of the housing with a screwdriver and route the wire into the plug, through the grommet.

The insert should be oriented so the wire comes out towards the bottom. Plug the square plug into the diverter block, and fix in place with a screw and rubber gasket.

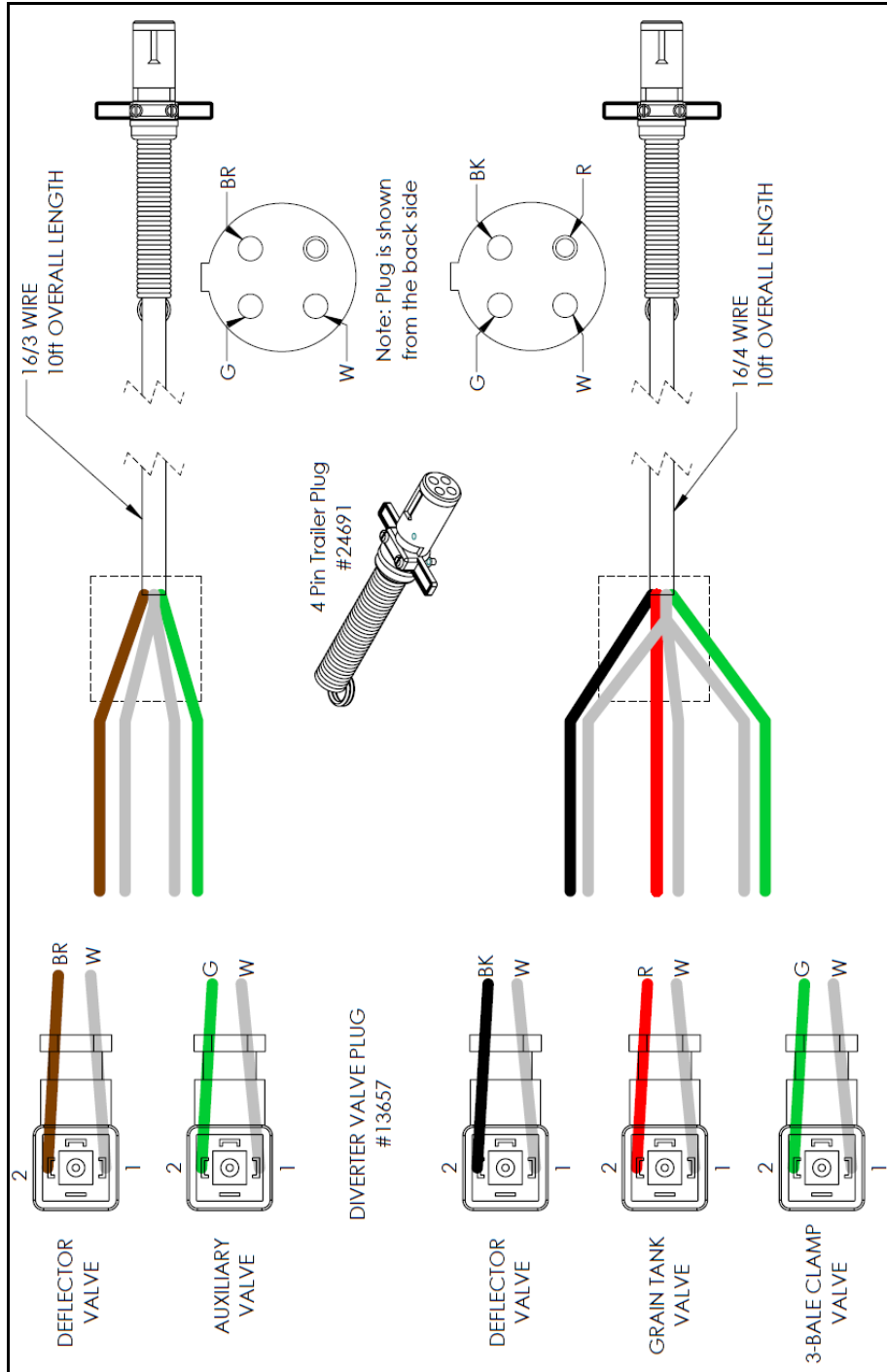

12.B9 Install fused switch box in cab of tractor and run 4-pin receiver end to back of the tractor. Attach it somewhere out of the way, but accessible. Run the other cable as desired so that it is on the ignition circuit of the tractor (black to positive, white to ground). See wiring diagram.

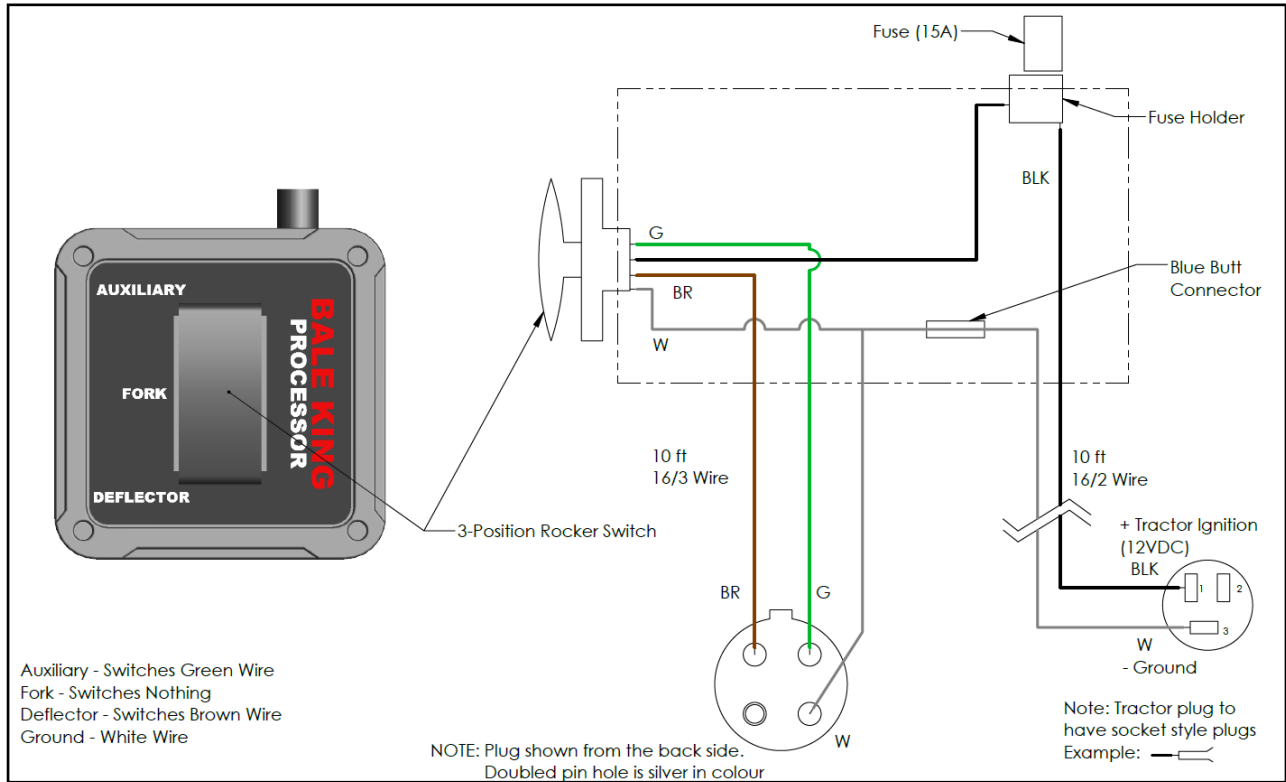

12.C1 Reorganize the hose holder as necessary to fit the new hoses

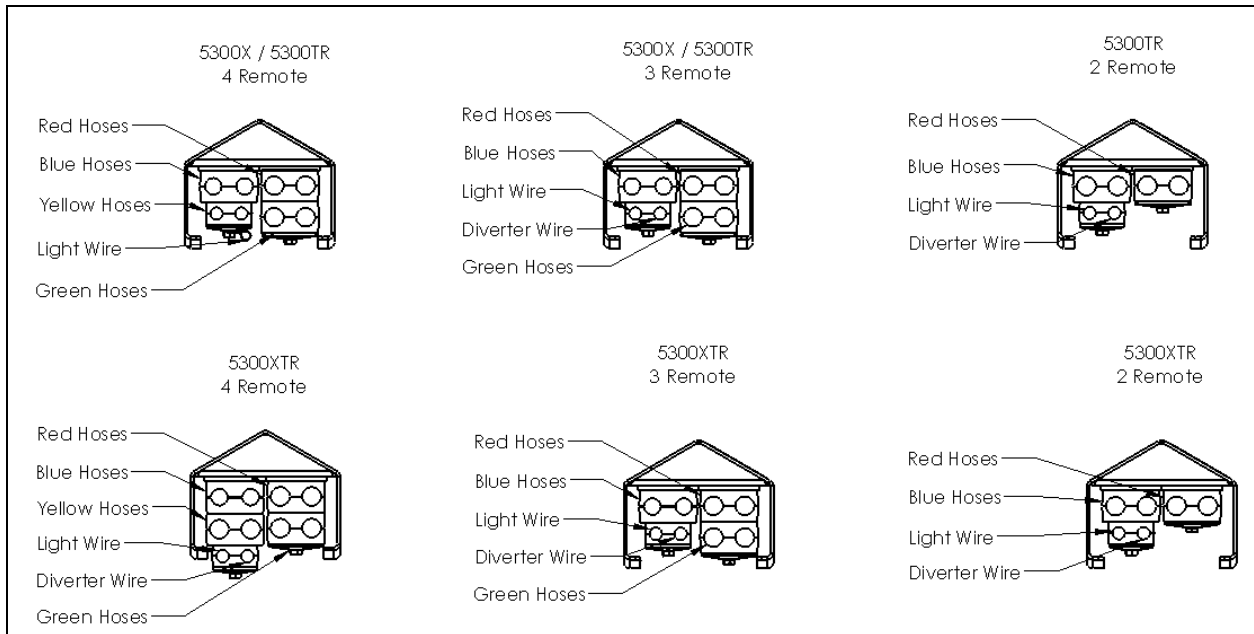

12.C2 Connect tractor to machine and check for function. With the rocker switch in the central (Fork) position, the hydraulic remote should operate the rear forks. With the rocker switch in the bottom (Deflector) position, the hydraulic remote should operate the side deflector.

STEP 13: Install auger spout. Adjust strap so it clamps tight. Adjust chain length for desired discharge position.

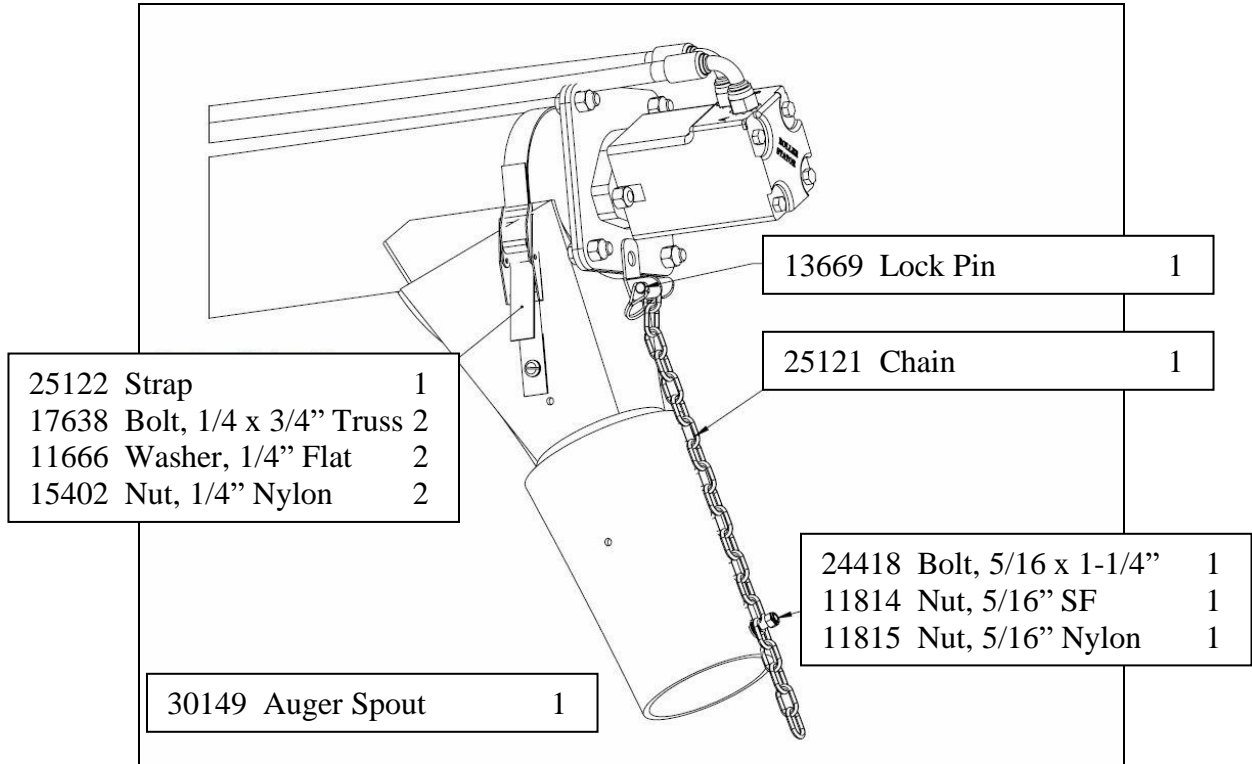

STEP 14: Reinstall spindle and tires.

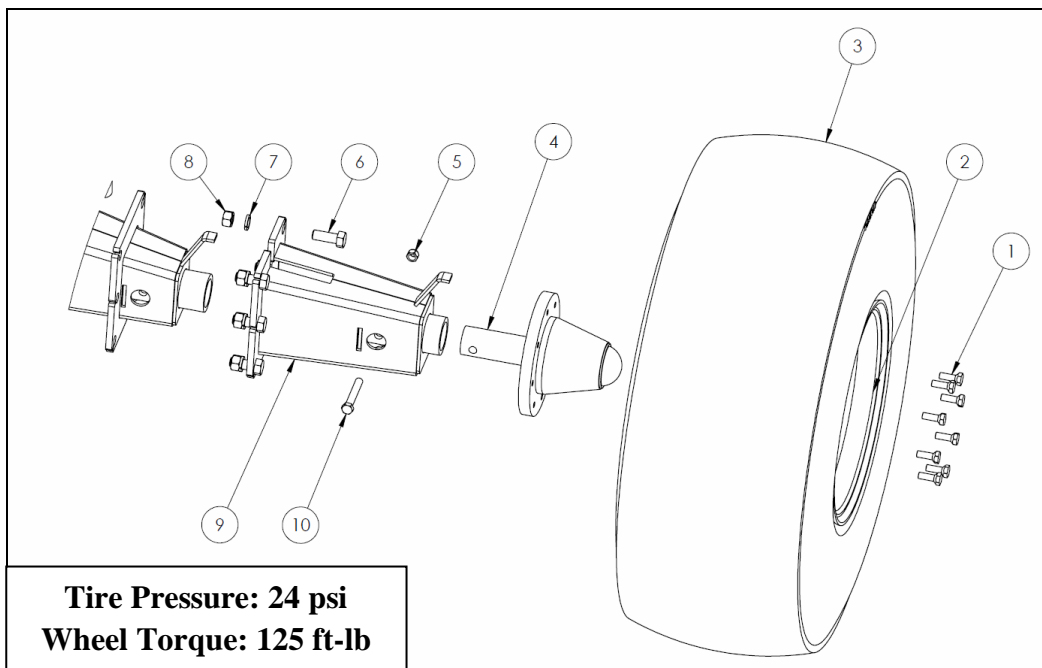

STEP 15: Reinstall SMV sign

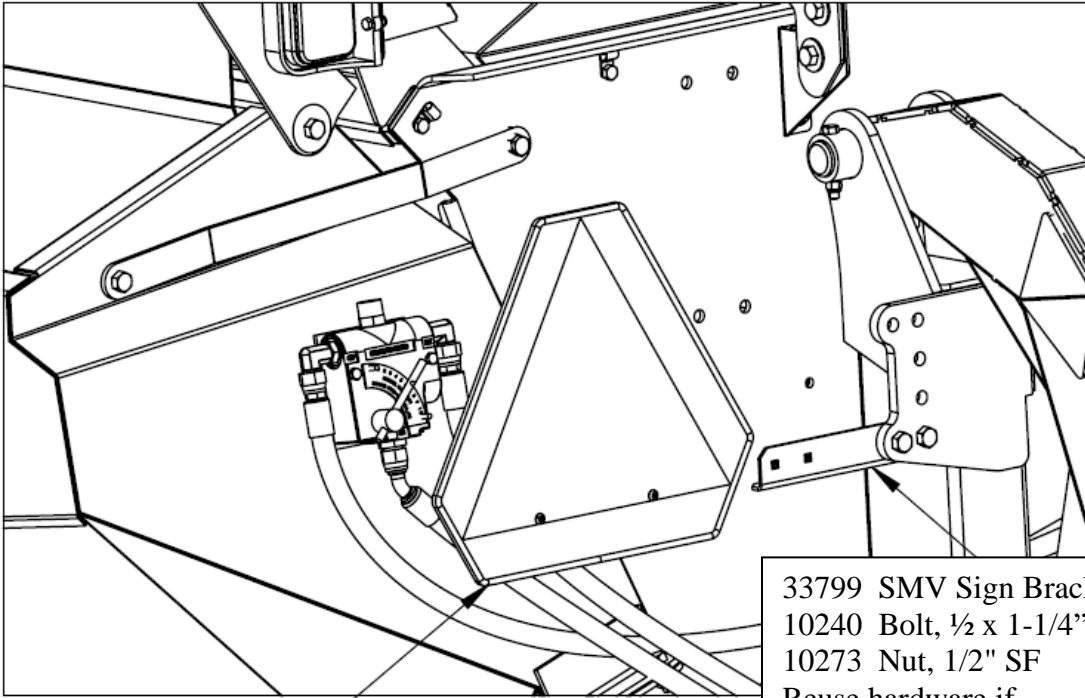

Relocate SMV Sign. Reuse mount hardware

33799 SMV Sign Bracket	1
10240 Bolt, 1/2 x 1-1/4"	2
10273 Nut, 1/2" SF	2
Reuse hardware if Three Bale Kit Installed	

PARTS MANUAL

NOTE: For a complete 5300 parts book, please see the Bridgeview Manufacturing website

Wheels & Hub

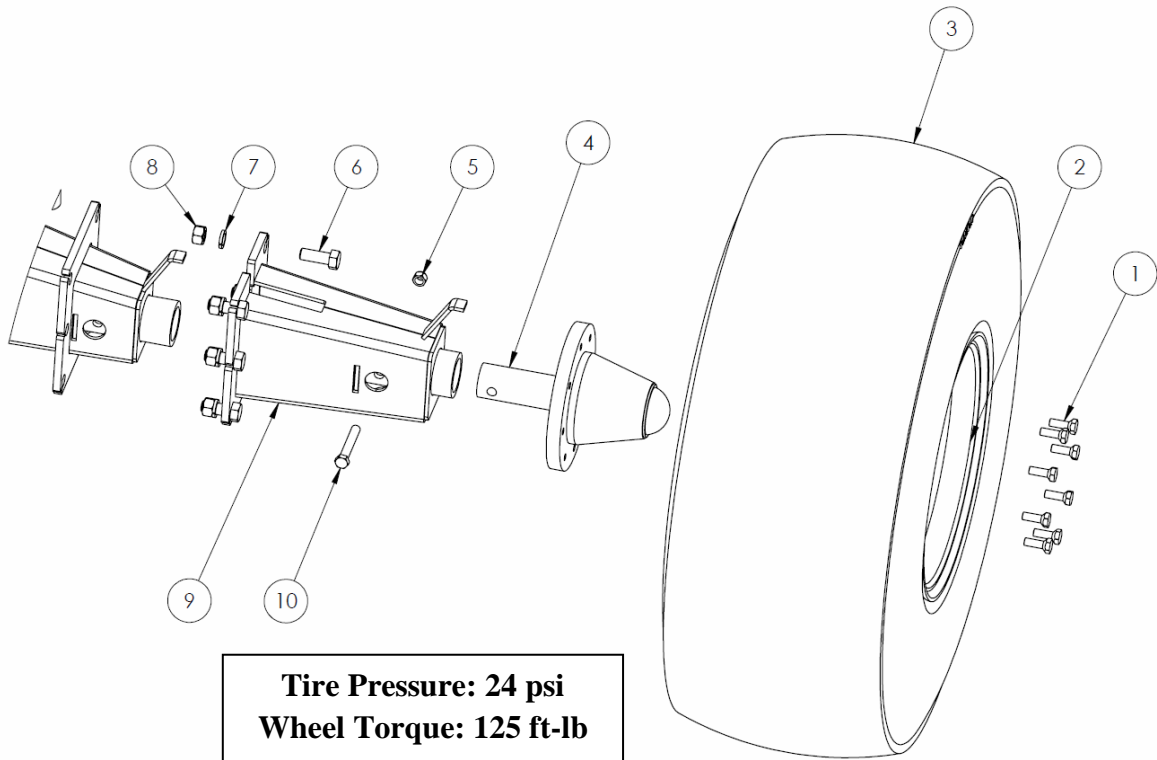

#	DESCRIPTION	PART #	QTY
1	Wheel Stud, 9/16 x 1-3/4" NF	10347	16
2	Rim, 16.1x14, 8 on 8"	10354	2
3	Tire, 16L-16.1 8 ply	See your local tire dealer	2
4	Spindle Assembly	See breakdown*	2
5	Stover Lock Nut, 9/16"	21165	2
6	Bolt, 3/4 x 2"	13800	6
7	Lock Washer, 3/4"	13795	6
8	Nut, 3/4"	10283	6
9	Axle Extension	*TR ONLY*	1
10	Bolt, 9/16 x 4"	33912	2

Spindle

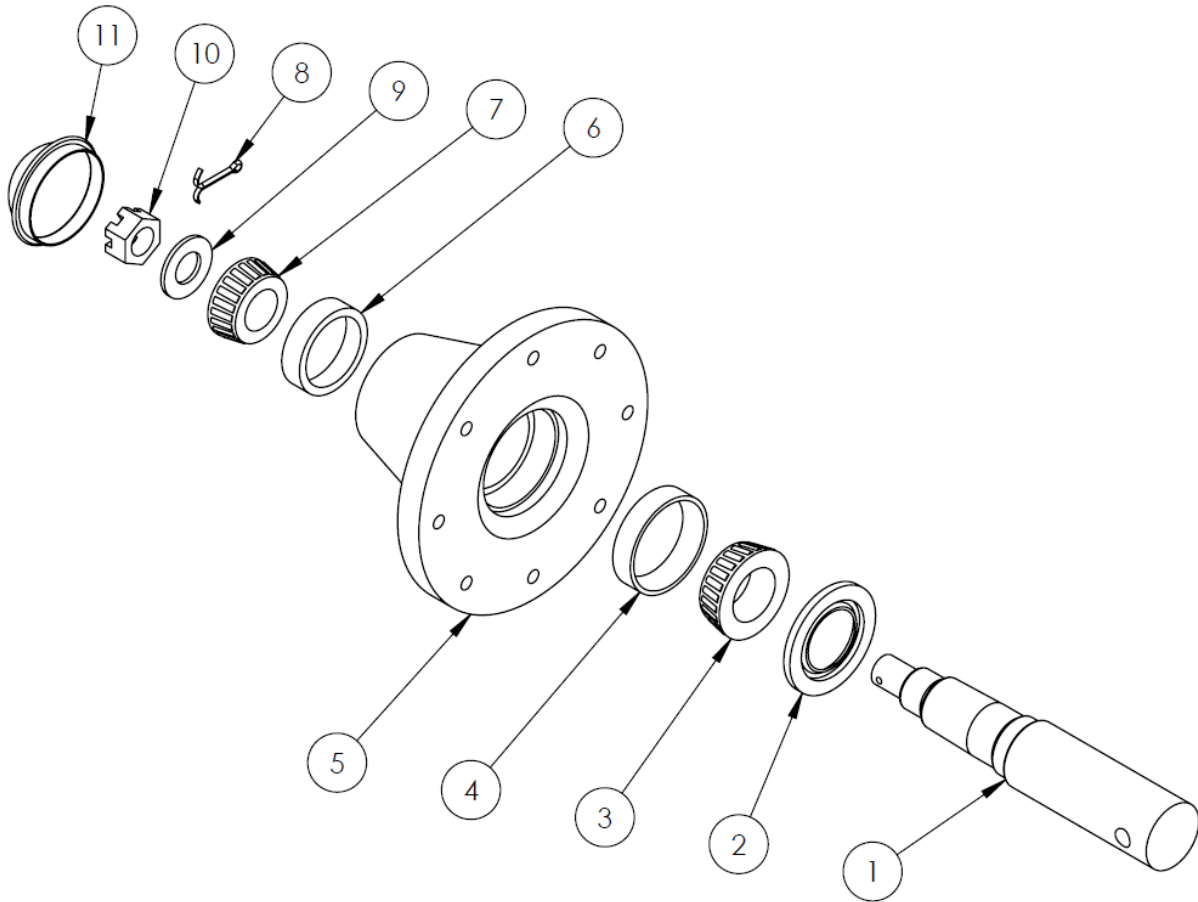

#	DESCRIPTION	PART #	QTY	
	Complete Assembly	29679	1	
1	6500lb Spindle	29730	2	
2	Seal, 2" ID	10344	2	
3	Inner Bearing Cone, 1.796" ID	LM25590	10345	2
4	Inner Bearing Race	25520	10349	2
5	Hub Housing	Includes #4 & #6	10343	2
6	Outer Bearing Race	25821	10346	2
7	Outer Bearing Cone, 1-3/8" ID	LM25877	10348	2
8	Cotter Pin, 3/16" x 1-1/2"		10072	2
9	Flat Washer, 1-1/6" ID x 2" OD		10071	2
10	Castle Nut, 1" NF		10153	2
11	Dust Cap		10350	2

Front Tub Components

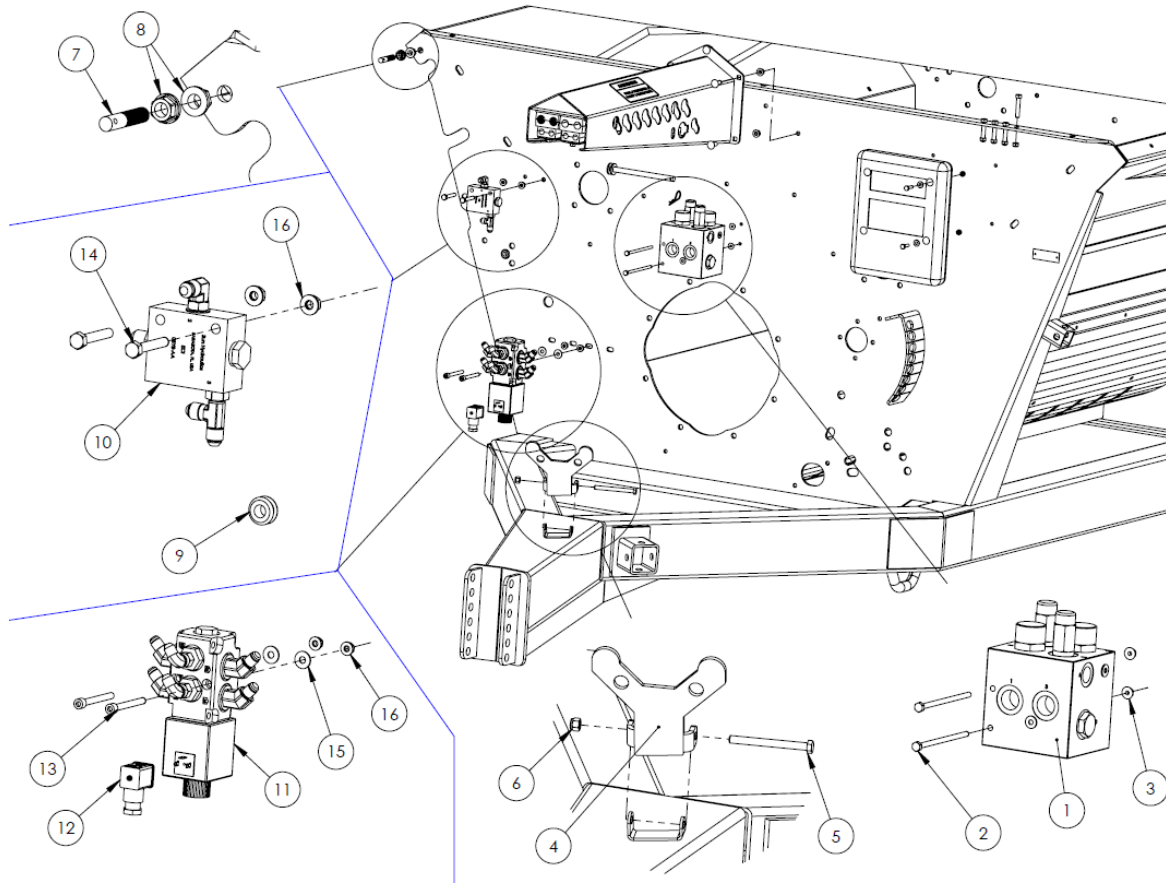

#	DESCRIPTION	PART #	QTY
1	Flow Divider Valve	25778	1
2	Bolt, 1/4 x 5"	25951	2
3	Nut, 1/4" Serrated Flange	11812	2
4	PTO Cradle	S/N BK7564 & below 31760	1
5	Bolt, 3/8 x 4"	S/N BK7564 & below 14379	1
6	Nut, 3/8" Nylon Lock	S/N BK7564 & below 10806	1
7	Threaded Pin	13231	1
8	Nut, 1/2" Serrated Flange	10273	2
9	Grommet	21428	2
10	Pilot Check Valve	19114	
11	Diverter Valve #	11743	1
	* Double Stack Kit	For joining 2 valves 12895	
	* Triple Stack Kit	For joining 3 valves 12897	
	* Nut & O-Ring Kit	17977	
	* Magnet Kit	11798	
12	Valve Plug	One per valve. Harness sold separately. 13657	-
13	Bolt, 5/16 x 3" Socket Head	11783	2
14	Bolt, 5/16 x 2"	15572	2
15	Washer, 5/16" Flat	12496	2
16	Nut, 5/16" Serrated Flange	11814	4

NOTE: See page 5353 for information on the control box

Slow Moving Vehicle (SMV) Sign Kit

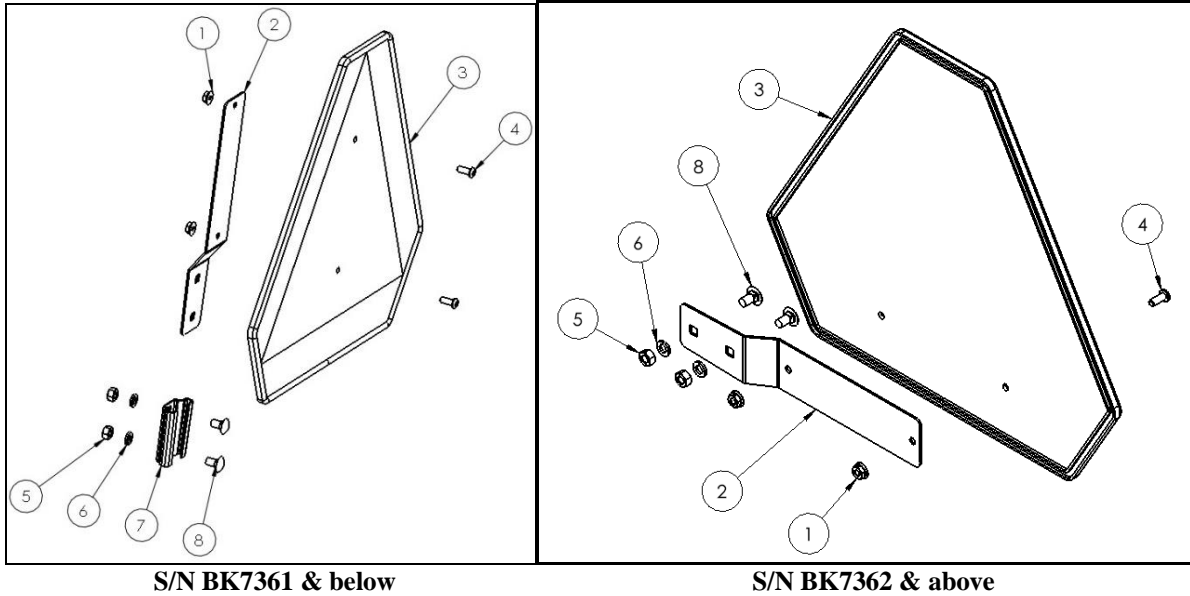

NOTE: Only the parts shown above are used on the Bale King 5300. Additional parts are included in the SMV sign kit which are not required.

#	DESCRIPTION	PART #	QTY
	Complete SMV Sign Kit	22411	1
1	Nut, 1/4" Nylon Lock	11664	2
2	Galvanized Sign Bracket	-	1
3	Plastic SMV Sign	-	1
4	Pan Head Bolt, 1/4" x 5/8"	-	2
5	Nut, 5/16"	-	2
6	Lock Washer, 5/16"	-	2
7	Galvanized Tapered Receiver Bracket	-	1
8	Carriage Bolt, 5/16" x 1/2"	-	2
9	Carriage Bolt, 5/16" x 2"	-	-
10	Lock Washer, 1/4"	-	-

PTO Holder

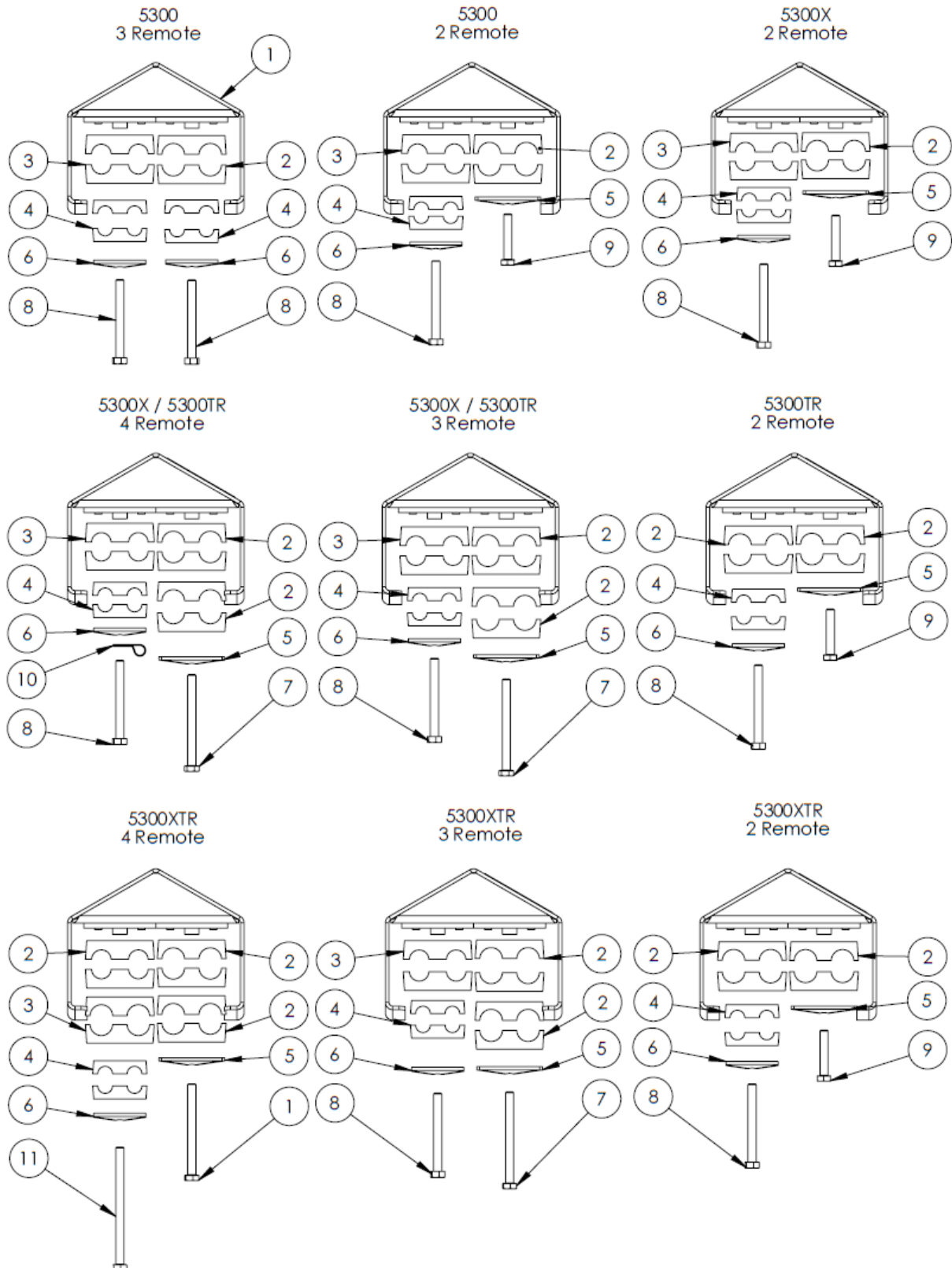

Hose Clamps...continued

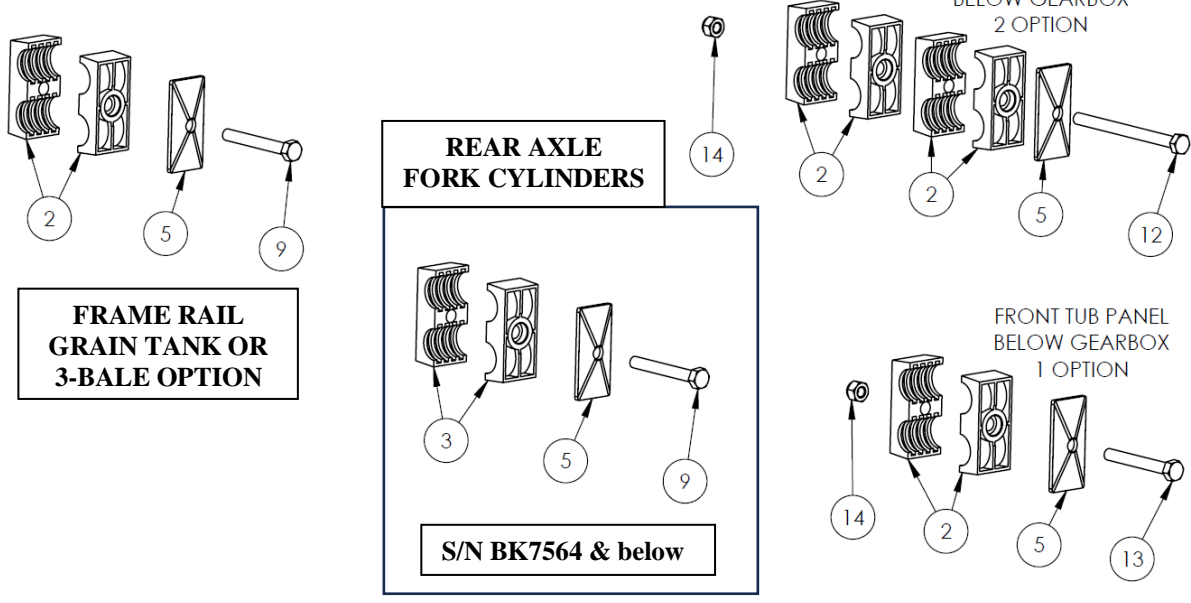

#	DESCRIPTION	PART #
1	Hose Holder	31740
2	Hydraulic Hose Clamp, 1/2"	21561
3	Hydraulic Hose Clamp, 3/8"	22180
4	Hydraulic Hose Clamp, 1/4"	22181
5	Hydraulic Hose Clamp Cap, Large	21725
6	Hydraulic Hose Clamp Cap, Small	22182
7	Bolt, 5/16" x 3-1/2"	13765
8	Bolt, 5/16" x 3"	22844
9	Bolt, 5/16" x 1-3/4"	21726
10	Wiring Clamp	13629
11	Bolt, 5/16" x 4-1/2"	21836
12	Bolt, 5/16 x 4"	31837
13	Bolt, 5/16 x 2-1/2"	19115
14	Nut, 5/16" Nylon Lock	11815

NOTE: Quantities are as required

Decals



5

2

6

3

4

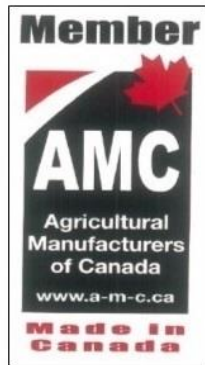

7

8



9



10

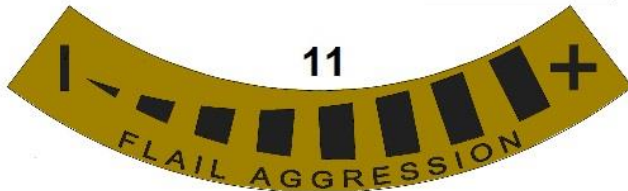

11

12

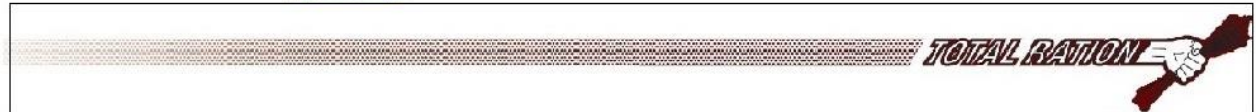

13



14

DECALS

#	DESCRIPTION	PART #	QTY
1	“BALE KING”	32804	2
	“5300”	31657	2
2	“DANGER”, PTO	12219	2
3	“DANGER”, Discharge	12230	4
4	“DANGER”, Stand Clear of Lift	12229	1
5	AMC Member	12239	1
6	FEMA Member	25347	1
7	Wheel Torque Reminder	28385	2
8	Deflector Safety Lock	22292	1
9	Red Reflector	28383	1
10	Amber Reflector	28384	4
11	Hoop Adjustment	32782	
12	Total Ration **TR Only**	24862	1
13	Speed Limit Decal	33159	
14(a)	Hyd. Decal (2 Remote Machine)	33138	1
14(b)	Hyd. Decal (0 Option, 3 Remote Machine)	33137	
14(c)	Hyd. Decal (1 Option, 3 Remote Machine)	33139	
14(d)	Hyd. Decal (2 Option, 3 Remote Machine)	33141	
14(e)	Hyd. Decal (1 Option, 4 Remote Machine)	33140	
14(f)	Hyd. Decal (2 Option, 4 Remote Machine)	33142	

***NOTE: Options refer to either the Three Bale Kit, or Total Ration Grain Tank Kit**

Total Ration Grain Tank Kit Option

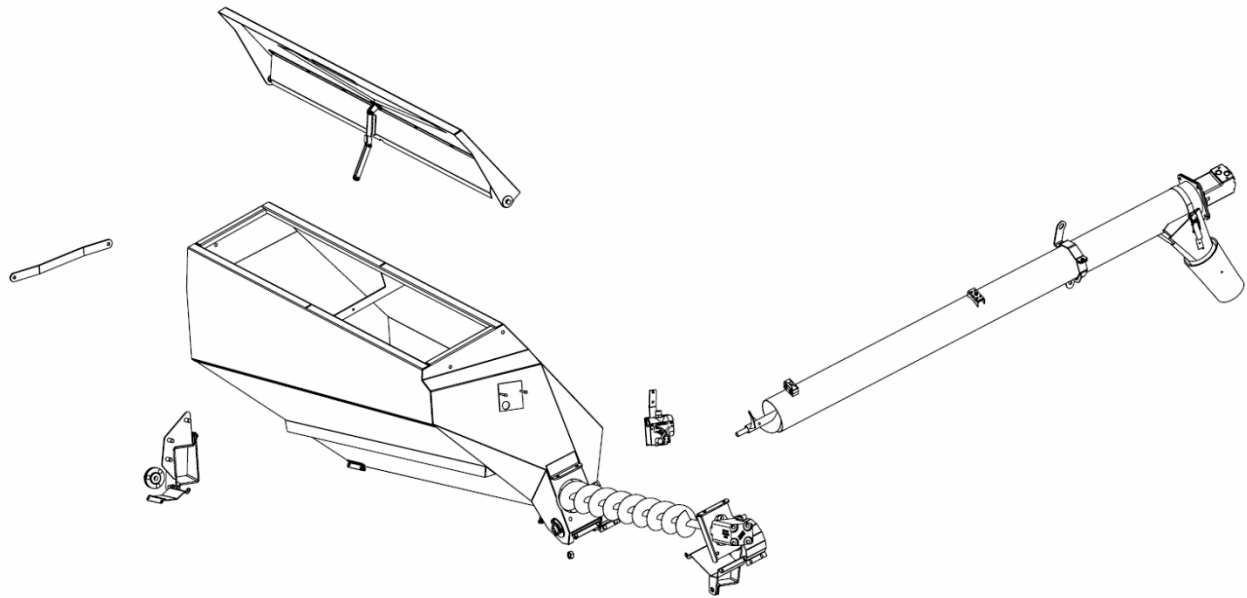

Item #	Description
1	Tank Front
2	Tank Rear
3	Cross Auger
4	Lid

Total Ration Tank Front

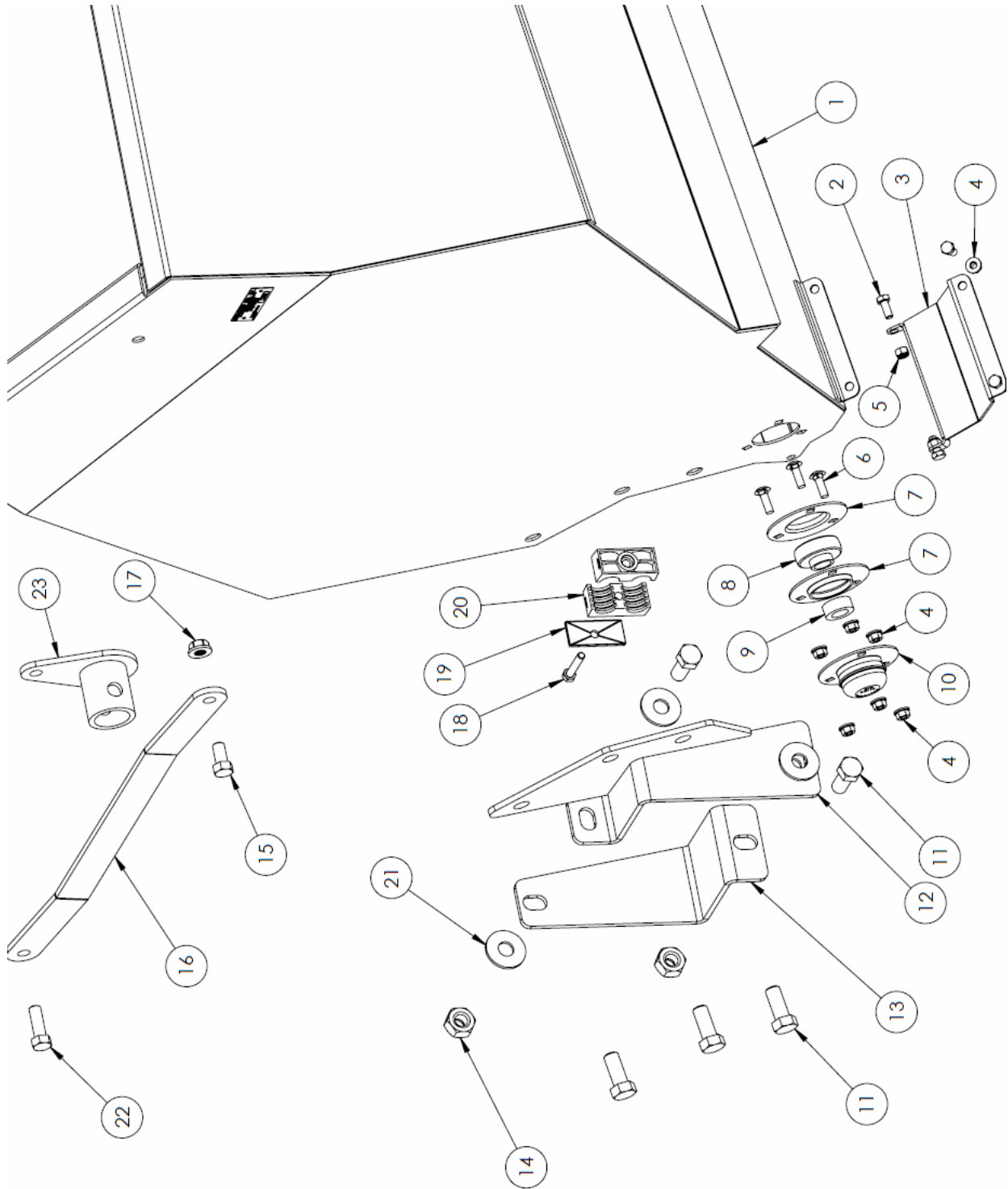

Total Ration Tank Front

#	DESCRIPTION	PART #	QTY
1	Total Ration Grain Tank	30199	1
2	Bolt, 5/16" x 3/4"	20903	4
3	Tank Cleanout Cover	30237	1
4	Nut, 5/16" Serrated Flange	11814	8
5	Nut, 5/16" Nylock	11815	2
6	Bolt, 5/16" x 1" Carriage	17884	3
7	Bearing, 3-Bolt Pressed Flange Housing	10368	2
8	Bearing, 3/4" Includes #9	10366	1
9	Bearing Lock Collar	10367	1
10	Bearing Cover	25117	1
11	Bolt, 5/8" x 1-1/2"	10173	5
12	5300 Front Mount Bracket	30242	1
13	5300 Front Mount Strap	30239	1
14	Nut, 5/8" Stover Lock	20150	2
15	Bolt, 1/2" x 1"	10824	2
16	Grain Tank Top Strap	30402	2
17	Nut, 1/2" Serrated Flange	10273	2
18	Bolt, 5/16" x 1.75"	21726	1
19	Hydraulic Hose Clamp Cap, Large	21715	1
20	Hydraulic Hose Clamp, 1/2"	21561	2
21	Washer, 5/8" Flat	13975	4
22	Bolt, 1/2" x 1-1/2"	10174	2
23	Jack Stow Position Mount 6200 ONLY	30501	1

Total Ration Tank Rear

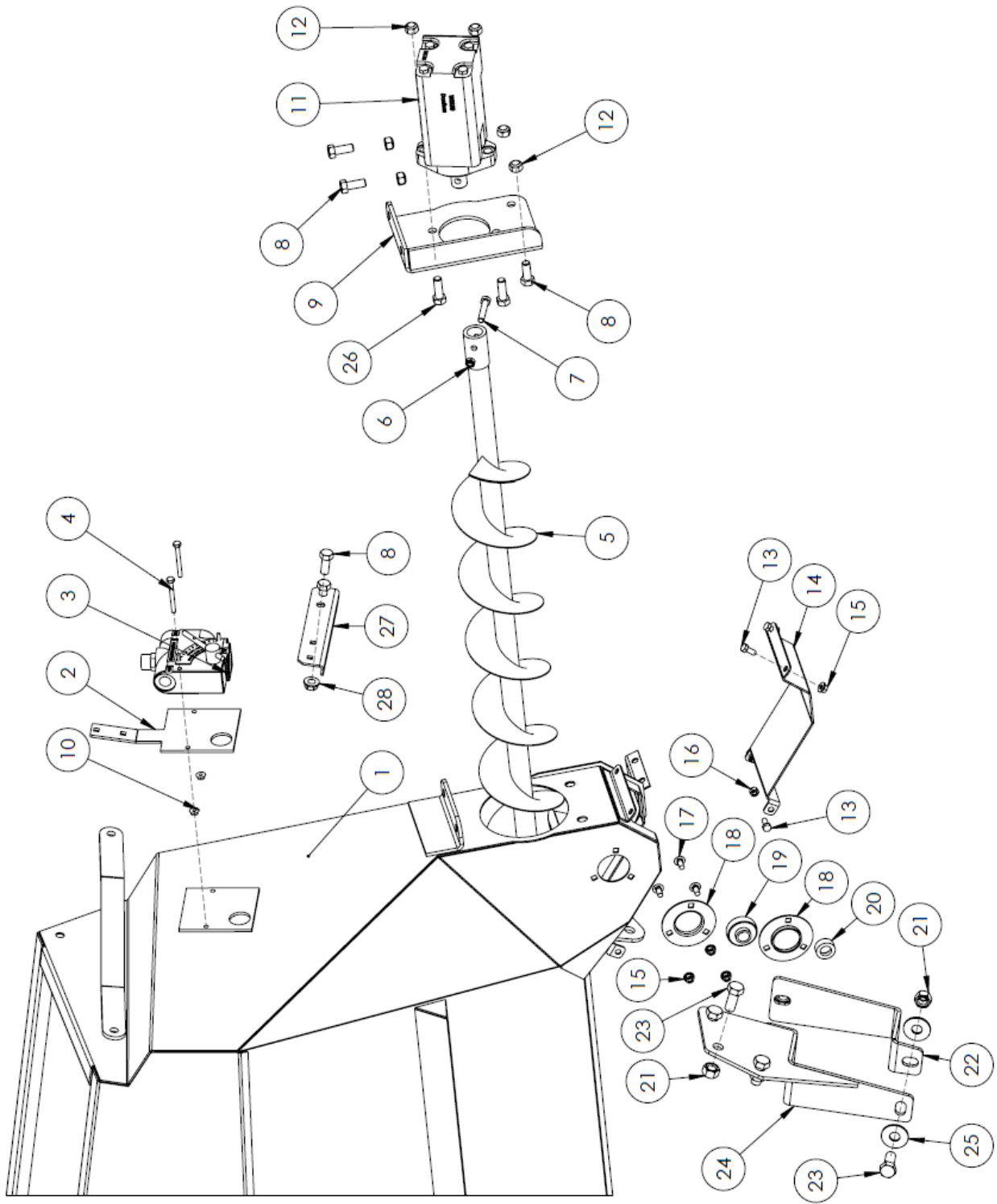

Total Ration Tank Rear

#	DESCRIPTION	PART #	QTY
1	Total Ration Grain Tank	30199	1
2	5300 SMV Sign Mount	S/N BK7253 & below 30389	1
3	Flow Control Valve	10455	1
4	Bolt, 1/4 x 2-1/2" Bolt, 1/4 x 2-3/4"	S/N BK7254 & up S/N BK7253 & below 20954 11811	2
5	Tank Auger	30175	1
6	Nut, 3/8" Stover Lock	17586	1
7	Bolt, 3/8" x 2"	10279	1
8	Bolt, 1/2 x 1-1/4"	10240	6
9	Tank Motor Mount	30233	1
10	Nut, 1/4" Serrated Flange	11812	2
11	Tank Motor, WS230	31172	1
12	Nut, 1/2" Stover Lock	14393	6
13	Bolt, 5/16 x 3/4"	20903	4
14	Cross Auger Cleanout Cover	30235	1
15	Nut, 5/16" Serrated Flange	11814	5
16	Nut, 5/16" Nylon Lock	11815	2
17	Bolt, 5/16 x 3/4" Carriage	11662	3
18	Bearing, 3-Bolt Pressed Flange Housing	10368	2
19	Bearing, 3/4"	Includes #20 10366	1
20	Bearing Lock Collar	10367	1
21	Nut, 5/8" Stover Lock	20150	5
22	5300 Rear Mount Strao	30245	1
23	Bolt, 5/8" x 1-1/2"	10173	5
24	5300 Rear Mount Bracket	30247	1
25	Washer, 5/8" Flat	13975	4
26	Bolt, 1/2 x 1-1/2"	10174	2
27	SMV Sign Bracket	S/N BK7254 & up 33799	1
28	Nut, 1/2" Serrated Flange	10273	2

Total Ration Cross Auger

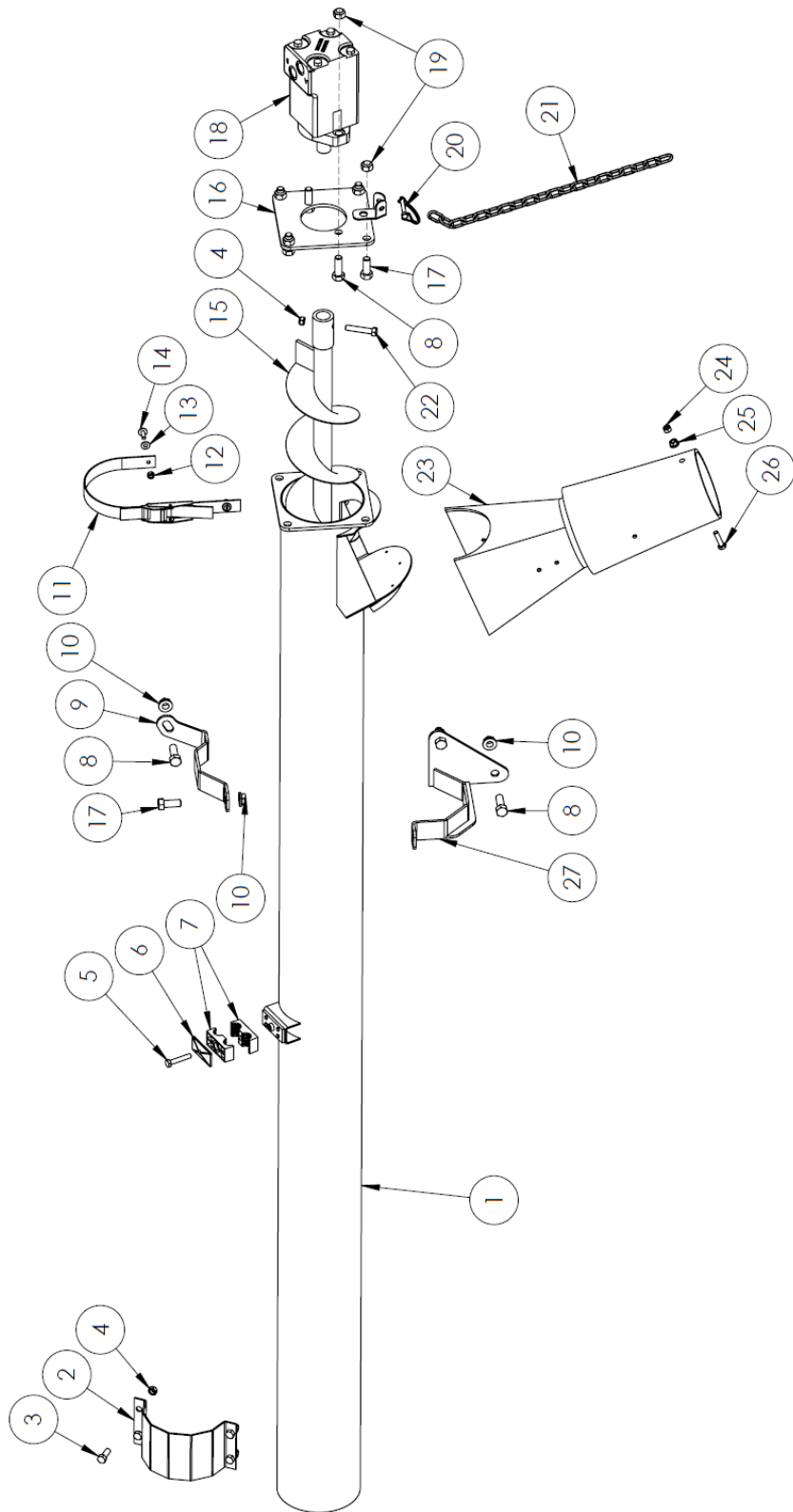



Total Ration Cross Auger

#	DESCRIPTION	PART #	QTY	
1	Cross Auger Pipe	30179	1	
2	Cross Auger Half Clamp	30401	1	
3	Bolt, 3/8" x 1"	13806	4	
4	Nut, 3/8" Stover Lock	17586	5	
5	Bolt, 5/16" x 1.75"	21726	1	
6	Hydraulic Hose Clamp Cap, Large	21715	1	
7	Hydraulic Hose Clamp, 1/2"	21561	2	
8	Bolt, 1/2" x 1-1/2"	10174	5	
9	Cross Auger Top Clamp	30187	1	
10	Nut, 1/2" Serrated Flange	10278	8	
11	Spout Strap	Includes both parts	25122	1
12	Nut, 1/4"	20891	2	
13	Washer, 1/4" Flat	14448	2	
14	Bolt, 1/4" x 3/4" Truss Head	17638	2	
15	Cross Auger	30169	1	
16	Cross Auger Motor Mount	30194	1	
17	Bolt, 1/2" x 1-1/4"	10240	4	
18	Cross Auger Motor, WS080	30132	1	
19	Nut, 1/2" Stover Lock	14393	6	
20	Lock Pin, 1/4" x 1.25"	13951	1	
21	Chain, 3/16" x 20 links	25121	1	
22	Bolt, 3/8" x 2"	10279	1	
23	Auger Spout	10543	1	
24	Nut, 5/16" Nylon lock	11815	1	
25	Nut, 5/16" Serrated Flange	11814	1	
26	Bolt, 5/16" x 1-1/4"	24418	1	
27	Cross Auger Bottom Clamp	30189	1	

Total Ration Tank Lid

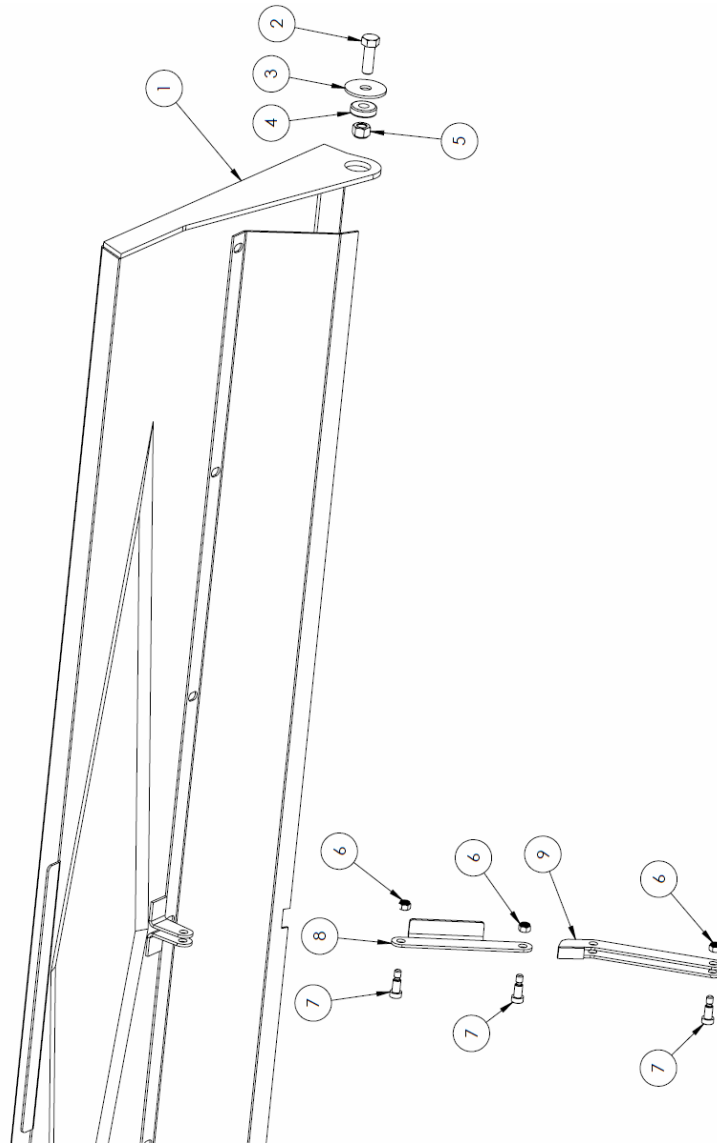

#	DESCRIPTION	PART #	QTY
1	Grain Tank Lid	30165	1
2	Bolt, 1/2" x 1-1/4"	10240	2
3	Washer, 1/2" Fender	10238	2
4	Bushing, 1/2" ID x 1.250" OD	10239	2
5	Nut, 1/2" Stover Lock	14393	2
6	Nut, 5/16" Nylon Lock	11815	3
7	Bolt, 3/8" x 5/8" Shoulder	30466	3
8	Lid Upper Support	30163	1
9	Lid Lower Support	30166	1

HYDRAULIC AND ELECTRICAL SCHEMATICS**Hydraulics****HYDRAULIC COMPONENTS**

#	DESCRIPTION	PART #
AA	Hydraulic Cylinder – 2.5 x 8 x 1.5” *Seal Kit	3 Bale Kit Arms 30126 17609
BB	WS230 Hydraulic Motor – WS230	Tank Auger 31172
CC	Hydraulic Cylinder - 3 x 18 x 1.5” * Seal Kit * Stopper Kit	Rear Forks 21717 20807 21860
DD	Hydraulic Cylinder - 1.5 x 6 x 1” * Seal Kit	Deflector 21711 23738
EE	Depth Control Valve	30980
FF	Flow Control Valve	TR Only 10455
GG	Diverter Valve * Nut & O-Ring * Magnet * Stack Kit *Triple Stack Kit	11743 17977 11789 12895 12897
HH	Pilot-operated Check Valve 5/16” x 2” Mounting Hardware x 2 5/16” Serrated Flange Nuts x 2	19114
II	Check Valve, 8MJ-8FB	12171
JJ	Pioneer Tip, 8FB	17379
KK	Hose Marker, Long Red	20791
LL	Hose Marker, Short Red	20790
MM	Hose Marker, Long Blue	34985
NN	Hose Marker, Short Blue	18497
OO	Hose Marker, Long Yellow	34984
PP	Hose Marker, Short Yellow	16520
QQ	Hose Marker, Long Green	20789
RR	Hose Marker, Short Green	16522
SS	Hydraulic Motor * Seal Kit	Agitator 25872 25891
TT	Flow Divider Valve	25778
UU	Hydraulic Motor – WS080	Cross Auger 30132

NOTE: Quantities vary depending on machine set-up. Order as required.

HYDRAULIC FITTINGS

#	DESCRIPTION	PART #
A	Adaptor, 10MB-8MJ	10161
B	Adaptor, 10MB-8MJ90	12169
C	Adaptor, 10MB-8MJ45	23844
D	Adaptor, 10MB-6MJ	11739
E	Adaptor, 10MB-6MJ45	22722
F	Adaptor, 8MBR-8MJT	22159
G	Adaptor, 8MB-6MJ	11740
H	Adaptor, 8MB-6MJ90	10200
I	Adaptor, 8MB-4MJ *not required if hose has 8MB end*	22160
J	Adaptor, 8MJ90BH	10531
K	Adaptor, 8MJ45BH	22189
L	Adaptor, 8FJXR-8MJT	11768
M	Adaptor, 6MBR-6MJT	23726
N	Adaptor, 6MB-6MJ	10162
O	Adaptor, 6MB-6MJ90	10201
P	Adaptor, 6MJBH90	10187
Q	Adaptor, 6MJ-6FJX90	12162
R	Adaptor, 6MB-6MJ Orifice (1/32")	17436
S	Adaptor, 8MJBH	28774
T	Adaptor, 12MB-8MJ	25937
U	Adaptor, 6MJBH	11767
V	Adaptor, 8MB Plug	31013
W	Adaptor, 12MB-8MJ90	22174
X	Adaptor, 6MJBH45	21319
Y	Adaptor, 8MB-6MB90	33739
Z	Adaptor, 6FJXR-6MJT	15760

NOTE: Quantities vary depending on machine set-up. Order as required.

HYDRAULIC HOSES

#	DIA.	LENGTH	ENDS	#	DIA.	LENGTH	ENDS
1	1/2"	160" OAL	8FJX - 8MB	26	1/4"	20.25" OAL	6FJX - 6FJX90
2	1/2"	33" OAL	8FJX - 8MB	27	1/4"	16.25" OAL	6FJX - 6FJX90L
3	1/2"	125" OAL	8FJX90 - 8MB	28	1/4"	13.5" OAL	6FJX - 6FJX
4	1/2"	48" OAL	8FJX - 8FJX	29	1/4"	12.25" OAL	6FJX - 6FJX90L
5	1/2"	98" OAL	8FJX - 8MB	30	3/8"	8.5" OAL	6FJX - 6FJX
6	1/2"	24" OAL	8FJX - 8FJX90	31	1/2"	81" OAL	8FJX - 8FJX
7	1/2"	44.5" OAL	8FJX - 8FJX90	32	1/2"	122" OAL	8MB - 8FJX
8	1/2"	102" OAL	8FJX90 - 8FJX	33	3/8"	78" OAL	6FJX - 8FJX
9	1/2"	122" OAL	8FJX - 8FJX90	34	3/8"	56" OAL	6FJX - 8FJX90
10	1/2"	42" OAL	8FJX - 8FJX45	35	3/8"	81" OAL	6FJX - 8FJX
11	1/2"	40" OAL	8FJX - 8FJX45	36	3/8"	24.5" OAL	6FJX - 6FJX
12	3/8"	122" OAL	6FJX - 8MB	37	3/8"	24" OAL	6FJX - 6FJX45
13	3/8"	79.5" OAL	6FJX - 6FJX	38	3/8"	28" OAL	6FJX - 6FJX45
14	3/8"	78" OAL	6FJX - 8FJX90	39	3/8"	87" OAL	6FJX - 6FJX45
15	3/8"	57.5" OAL	6FJX - 8FJX	40	3/8"	29" OAL	8FJX - 6FJX45
16	3/8"	35.5" OAL	6FJX - 8FJX	41	3/8"	26" OAL	8FJX - 6FJX90
17	3/8"	33.5" OAL	6FJX - 8FJX	42	3/8"	38" OAL	8FJX - 6FJX90
18	3/8"	17.25" OAL	6FJX - 6FJX90	43	3/8"	30" OAL	6FJX - 6FJX90
19	3/8"	13.5" OAL	6FJX - 6FJX	44	3/8"	28" OAL	6FJX - 6FJX
20	3/8"	11.25" OAL	6FJX - 6FJX90	45	3/8"	24" OAL	6FJX - 6FJX
21	3/8"	9.25" OAL	6FJX - 6FJX	46	3/8"	47" OAL	6FJX - 6FJX90
22	3/8"	8.75" OAL	6FJX - 6FJX	47	3/8"	58" OAL	6FJX - 6FJX
23a	1/4"	131" OAL	4FJX - 6FJX90L	48	3/8"	29.5" OAL	8FJX - 8FJX
23b		139" OAL	(8MB-6FJX90L * if available *)	49	3/8"	29" OAL	6FJX - 6FJX90
				50	3/8"	25" OAL	6FJX - 6FJX90
24	1/4"	35" OAL	6FJX - 6FJX90	51	3/8"	16" OAL	6FJX - 8FJX
25	1/4"	26" OAL	6FJX - 6FJX90	52	3/8"	14.25" OAL	6FJX - 8FJX

NOTE: Quantities vary based on machine set-up. Hoses are not available for sale.

Use the information above to have replacement hoses made up locally.

All hoses should be double braid, with crimps rated for at least 3500 psi.

FRONT PANEL – 1 OPTION, 4-REMOTE

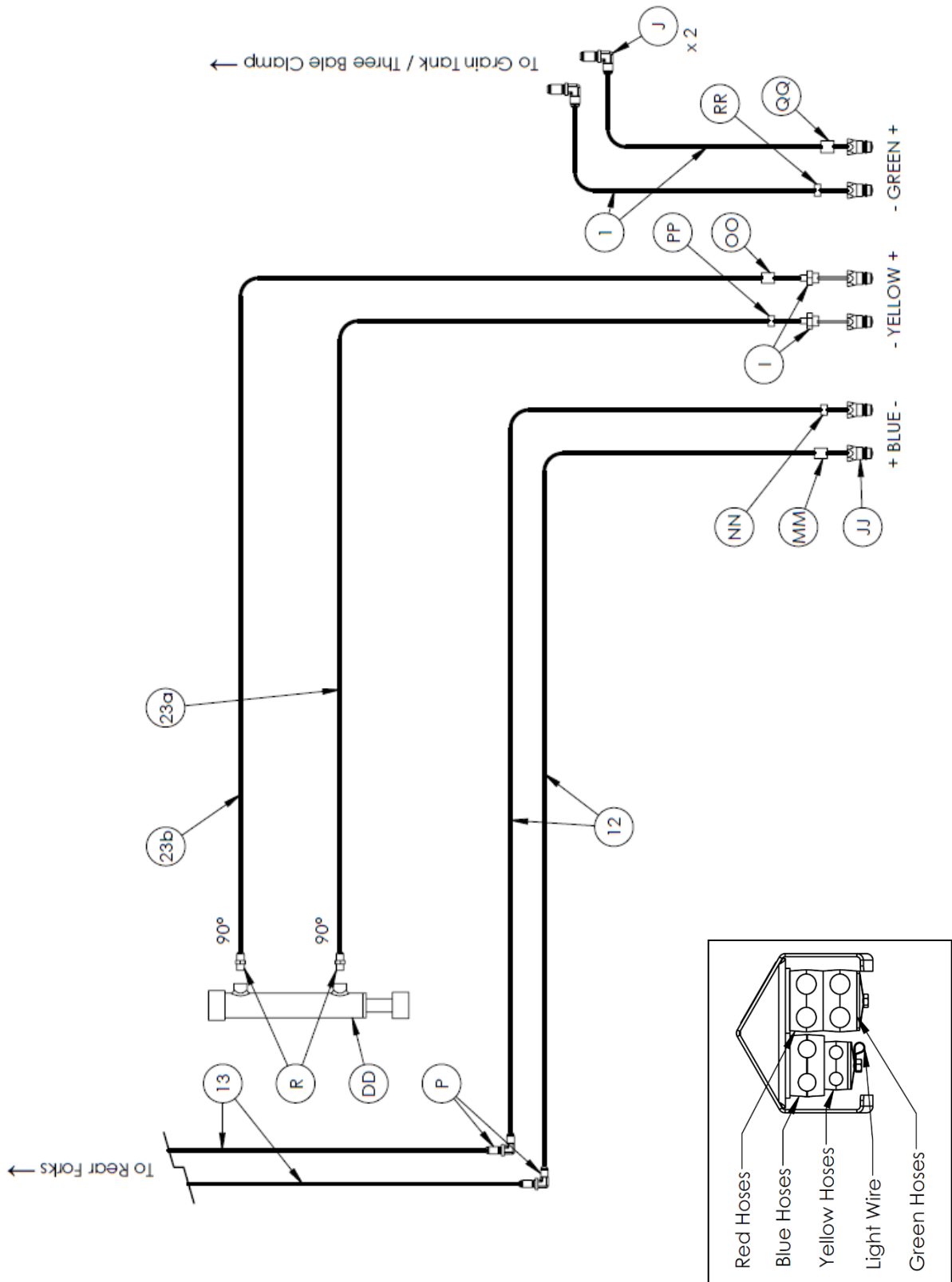

FRONT PANEL – 1 OPTION, 2-REMOTE

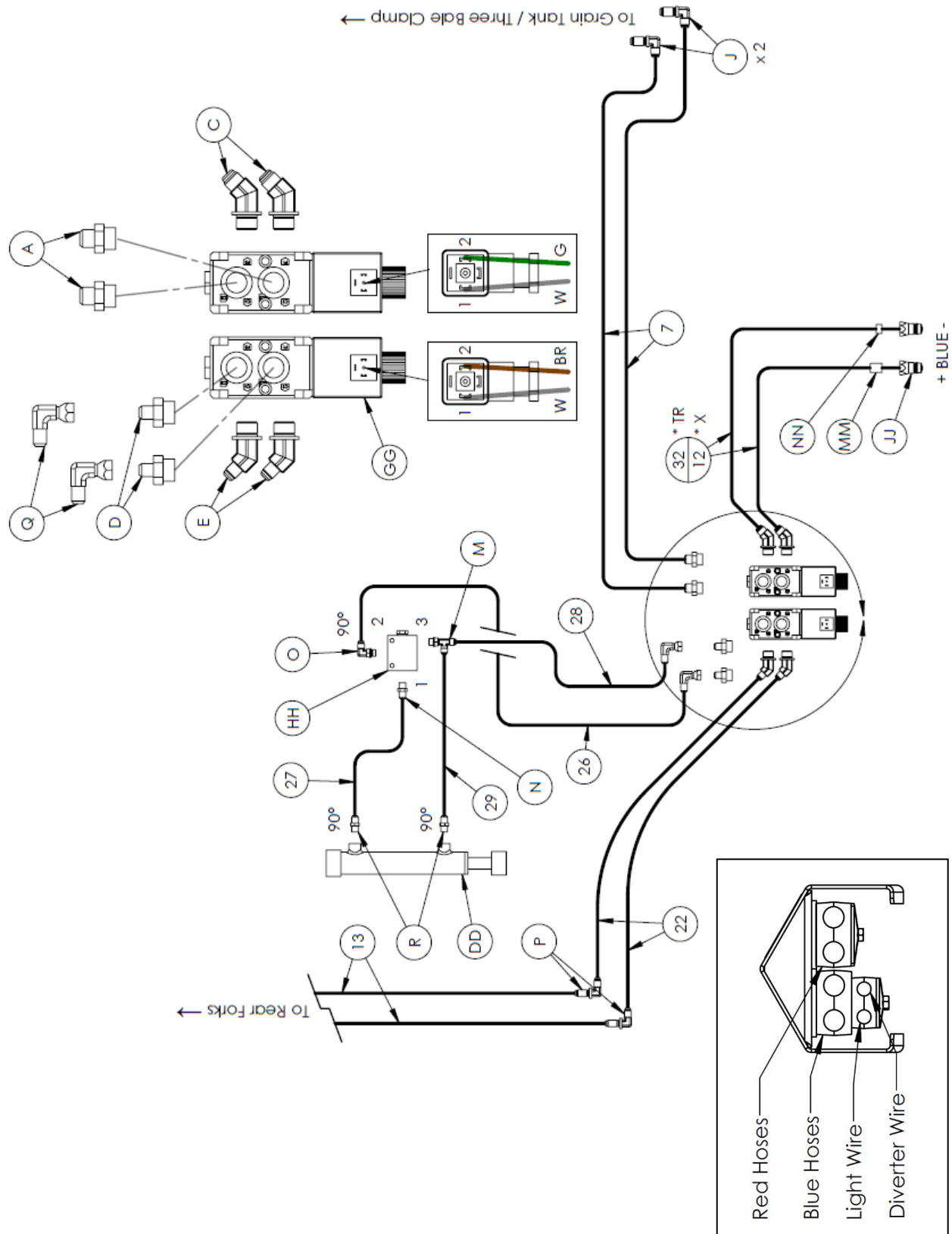

FRONT PANEL – 2 OPTION, 3-REMOTE

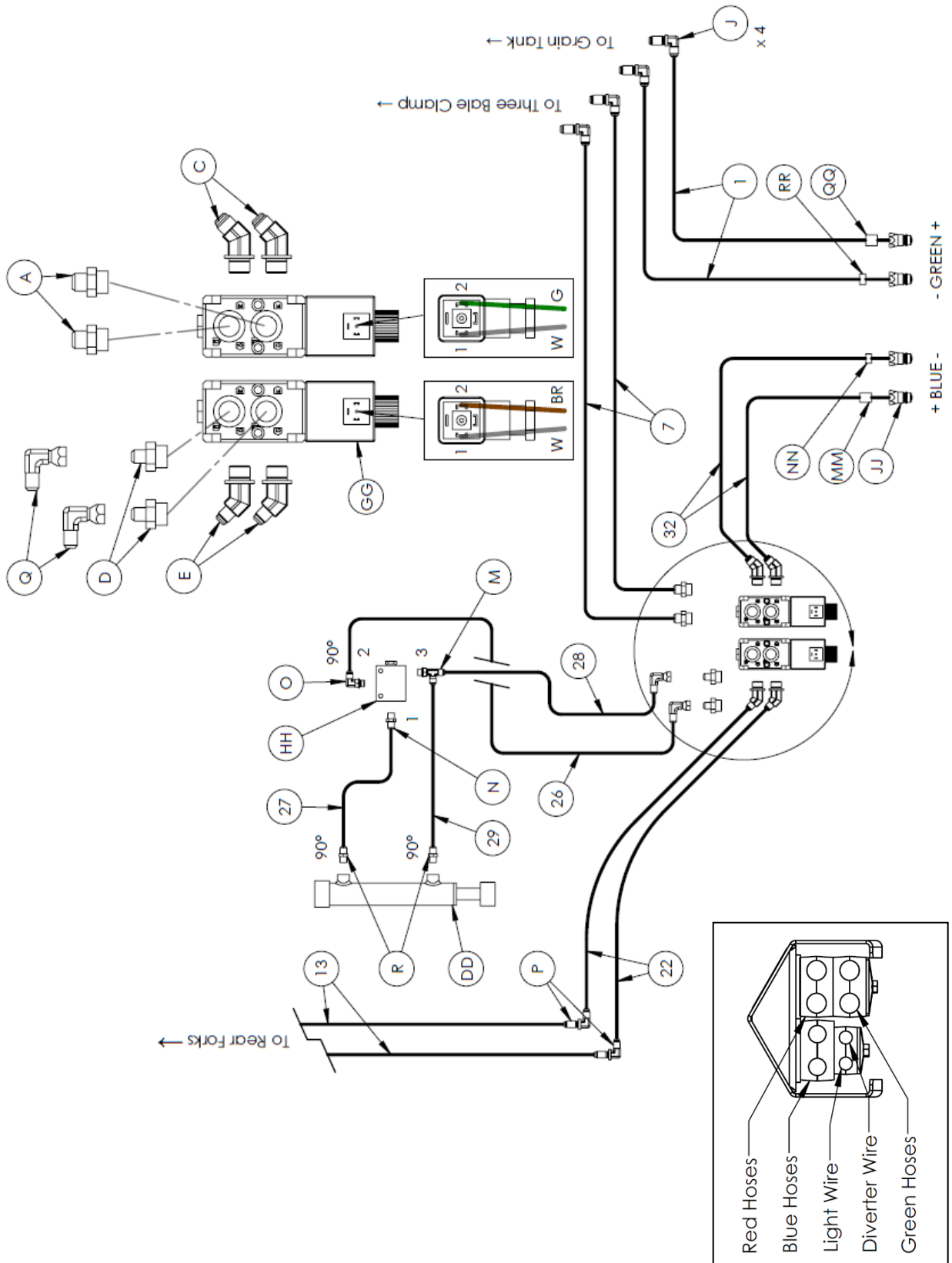

FRONT PANEL – 2 OPTION, 2-REMOTE

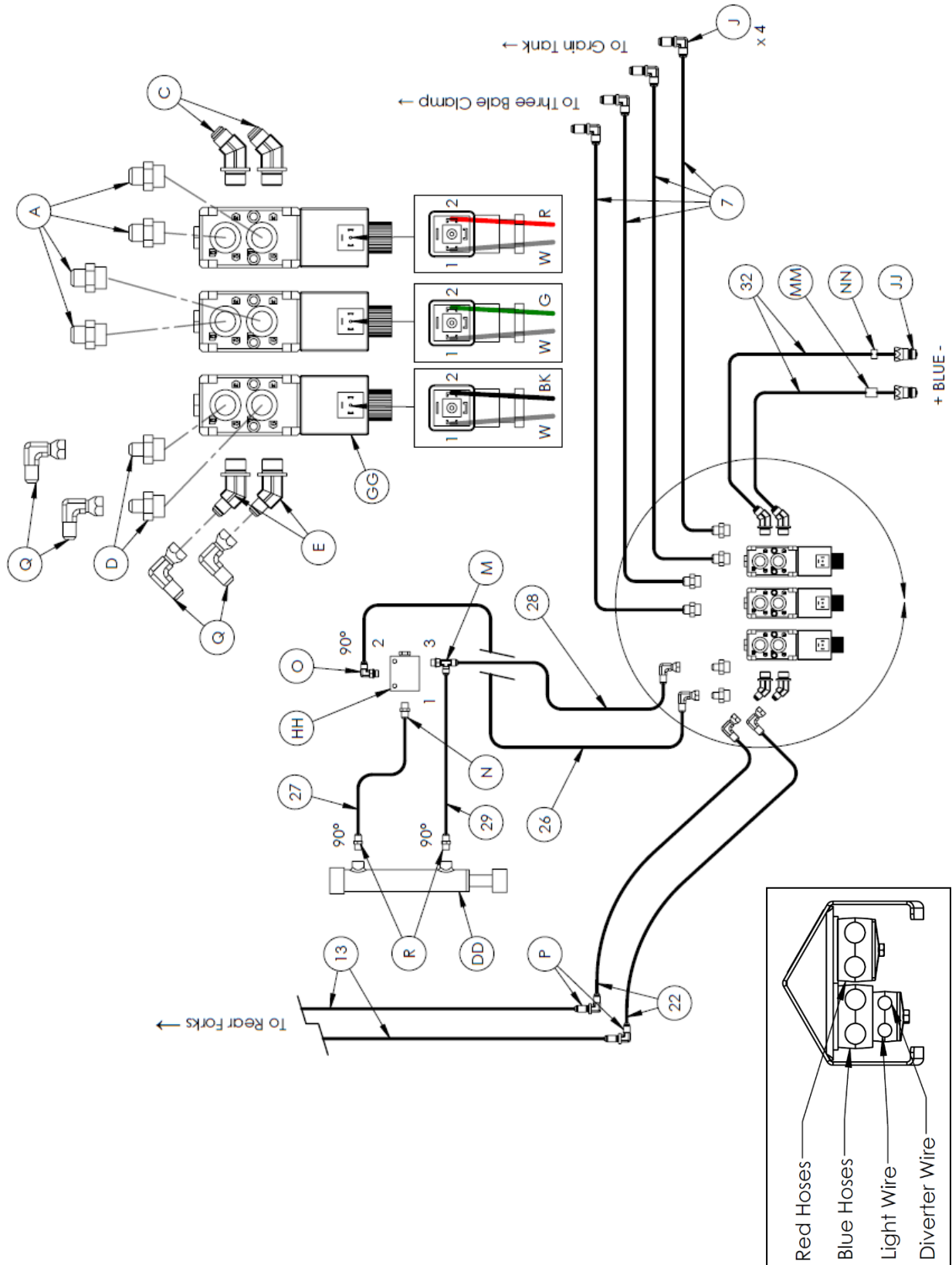

TR GRAIN TANK KIT

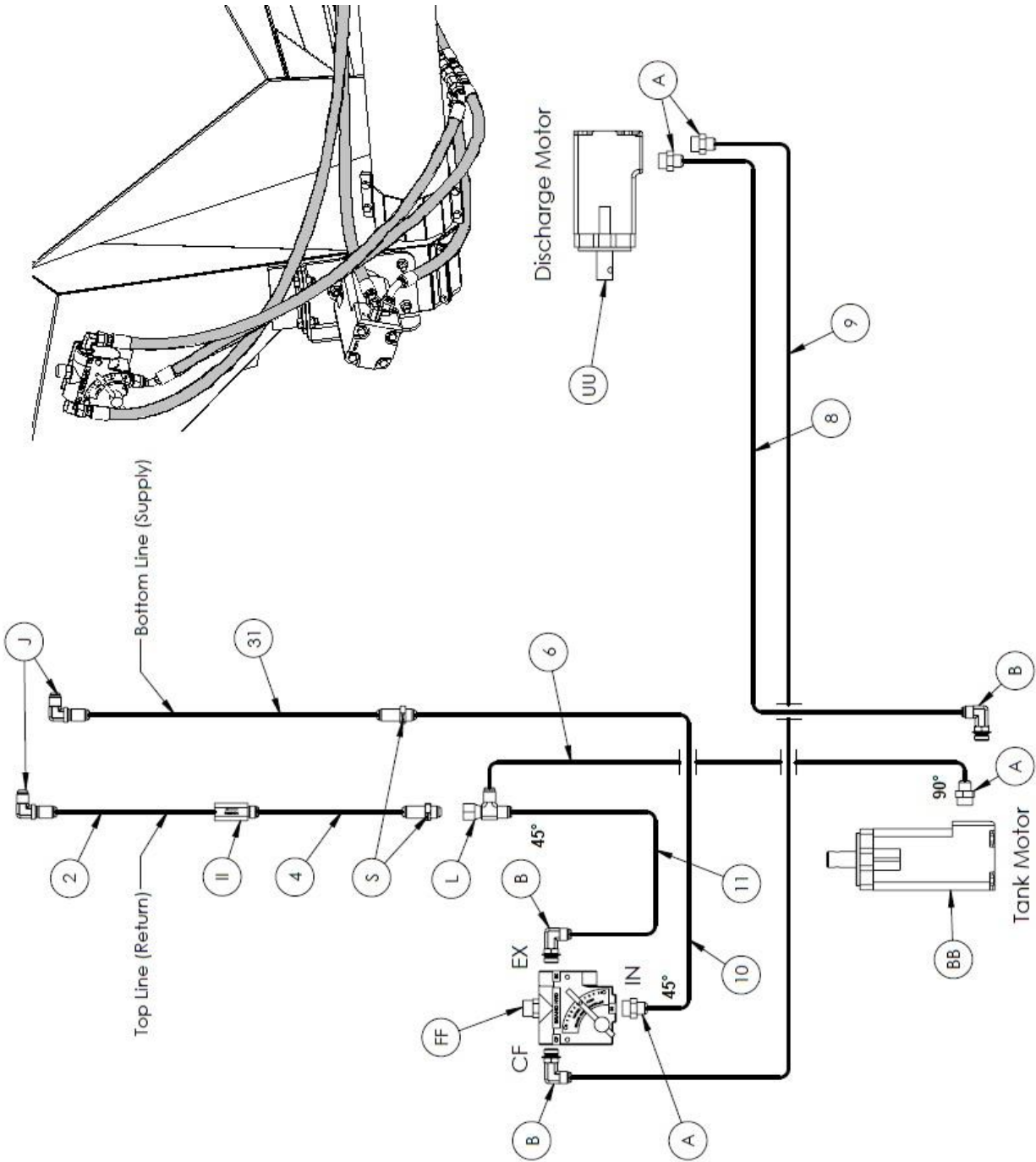

Diverter Control Box

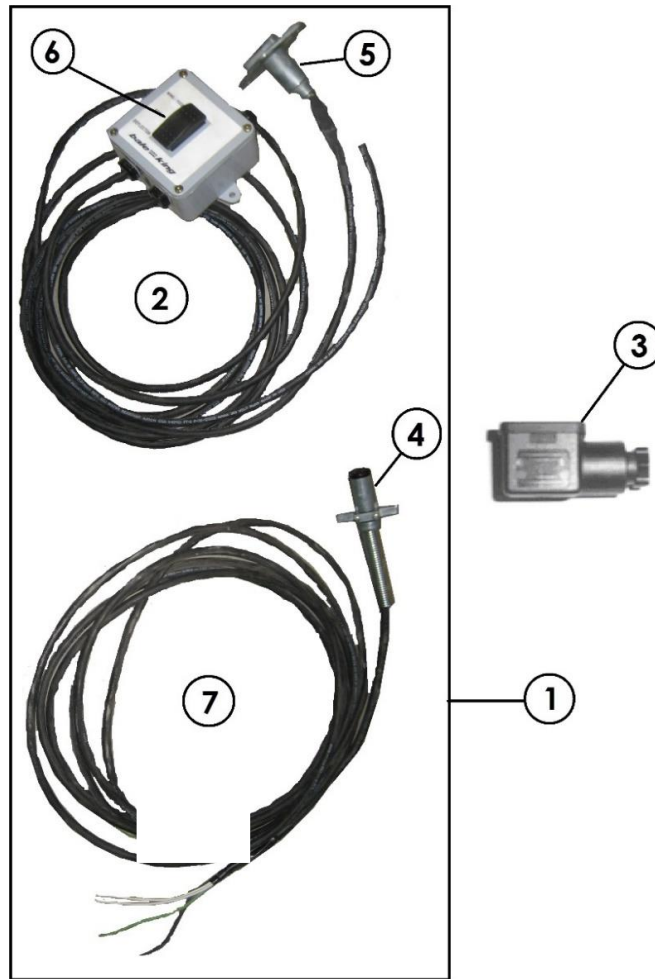

#	DESCRIPTION	PART #	QTY
1	Complete Control Box with Harness (Standard)	24466	1
	Complete Control Box with Harness (4 Function) #	33134	
2	Complete Control Box with Cab to Hitch Harness (5300 Series)	-	1
3	Square Plug for Diverter Valve	13657	*
4	4-pin Trailer Plug	24691	1
5	4-pin Tractor Plug	24690	1
6	3-way Switch	13561	1

* **NOTE:** 1 plug is needed for each diverter valve.

NOTE: Only used on 5300XTR with 2-remote kit (3 diverter valves)

Diverter Machine Side Harness

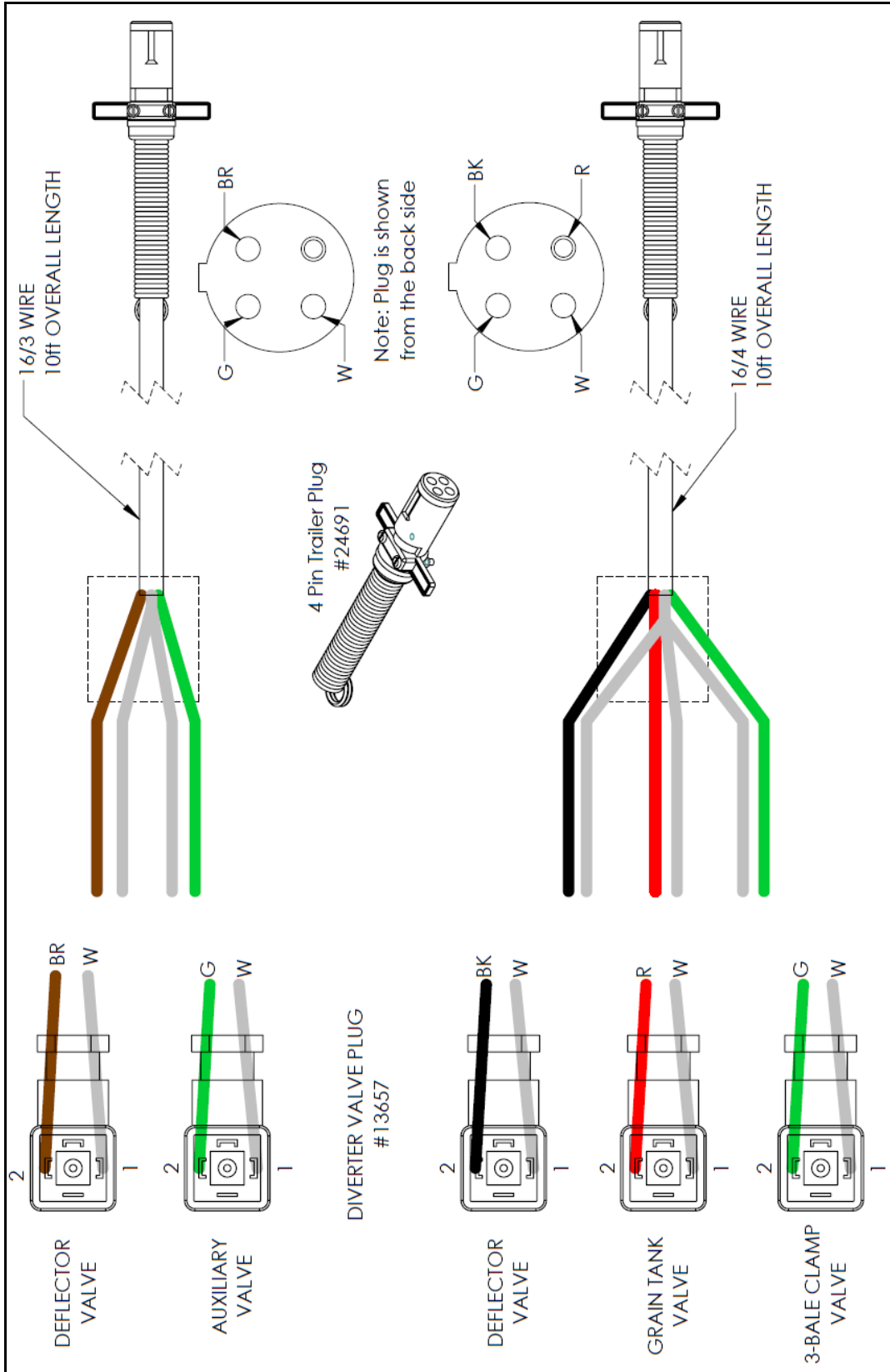

Diverter Control Box #24466

